



Service information

Reference no.: SDA_112779

Symptom

Mandatory Action: Secure Thermoprotector after replacing or disconnecting the pump

Cure

CURE:

The Thermoprotector has to be secured with hot glue in following cases:

- after pump was replaced
- if pump was disconnected during repair procedure

This action needs to be done to guarantee the correct functionality of the pump and to ensure safety standard.

Action:

To guarantee a correct adhesion of the thermoprotector, use a hot glue type with a working temperature of 180°C at least as per our technical specifications indicated in the data sheet attached, and proceed by the follow instructions:

- 1) Insert the thermal protector in the seat on the pump (Pict. 1)



- 2) Once the pump connector is placed, apply the hot glue on both sides and out of the slit of the thermal protector (see Pict. 2 and Pict. 3)



Warning: do not directly apply the hot glue inside the seat, between the body of the pump and the body of the thermal protector, before the pump connector is in the seat (see Pict. 4)

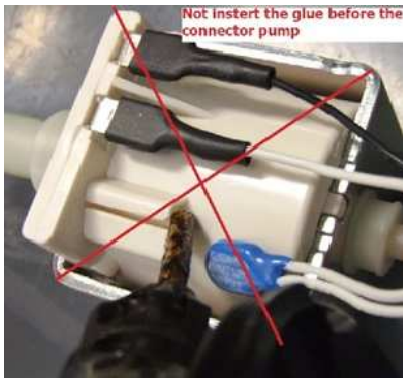

(Pict. 4)

It must be use a hot glue with a working temperature at least of 180°C or higher, that is a commercial component available in all principal industrial tools and accessories distributor.

ADDITIONAL INFORMATION:

SERIAL NUMBER (First serial where solution has been implemented in production):
None

IPM NUMBER (Philips Integrate Problem Management documentation reference number):
None

FAQ NUMBER (for Call Center reference):
None

INFORMATION FOR CALL CENTER:
None

INFORMATION FOR CONSUMER:
None

HISTORY: (In green color the changes)

14/06/2016 – Fifth release: changed headline
12/05/2016 – Fourth release: removed SDA Mandatory and attached technical specifications of the glue.
29/03/2016 – Third release: SDA modified in Mandatory
02/03/2016 – Second release: added informations in INFO
05/02/2016 – First release