



Service information

Reference no.: SDA_94868

Symptom

GC86xx Carry lock tight

Cure

Symptoms:

- Carry lock tight after carry lock release button is pressed.
- Carry lock unlock slowly after carry lock release button is pressed.

Product affected:

- GC86xx (All date code before wk1233)

Root cause of failure:

- Due to less optimal clearance in the carry lock sliding.

Symptom Cure:

- Replace the faulty front lock assy with a new front lock assy (Service code: 2439 021 70783).

Front lock assy
Service code: 423902170783

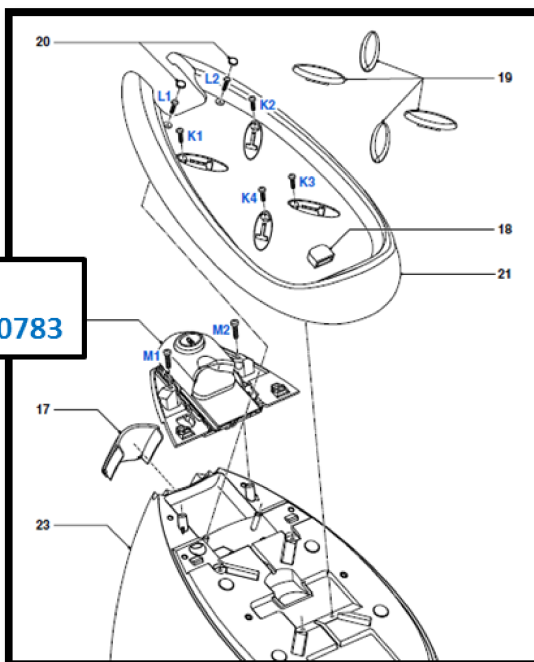

Remarks:

- Product corrective action: All GC86xx products with date code > wk1233 will have the improved carry lock installed during production.