

Service
Service
Service



Philips Consumer Lifestyle

Service Manual

PRODUCT INFORMATION

Service scenario:

- Repair
- Parts exchange

General:

- Rechargeable
- World-wide automatic voltage selection

Safety information

- This product meets the requirements regarding interference suppression on radio and TV.

TECHNICAL INFORMATION

- Voltage : 100 - 240 Volt
- Motor Voltage : 3,6 Volt
- Stand-by power : 0,5 W
- Max power consumption : 5,4 W
- Charging time : 8 hours
- Shaving time : up to 40 min
- Shaving heads USA : HQ7
- ROW : HQ8
- SAP coding : AT790

OPTIONAL (accessories)

- 4222 036 21751 Power plug EU
- 4222 036 23881 Power plug GB
- 4222 036 22121 Power plug US

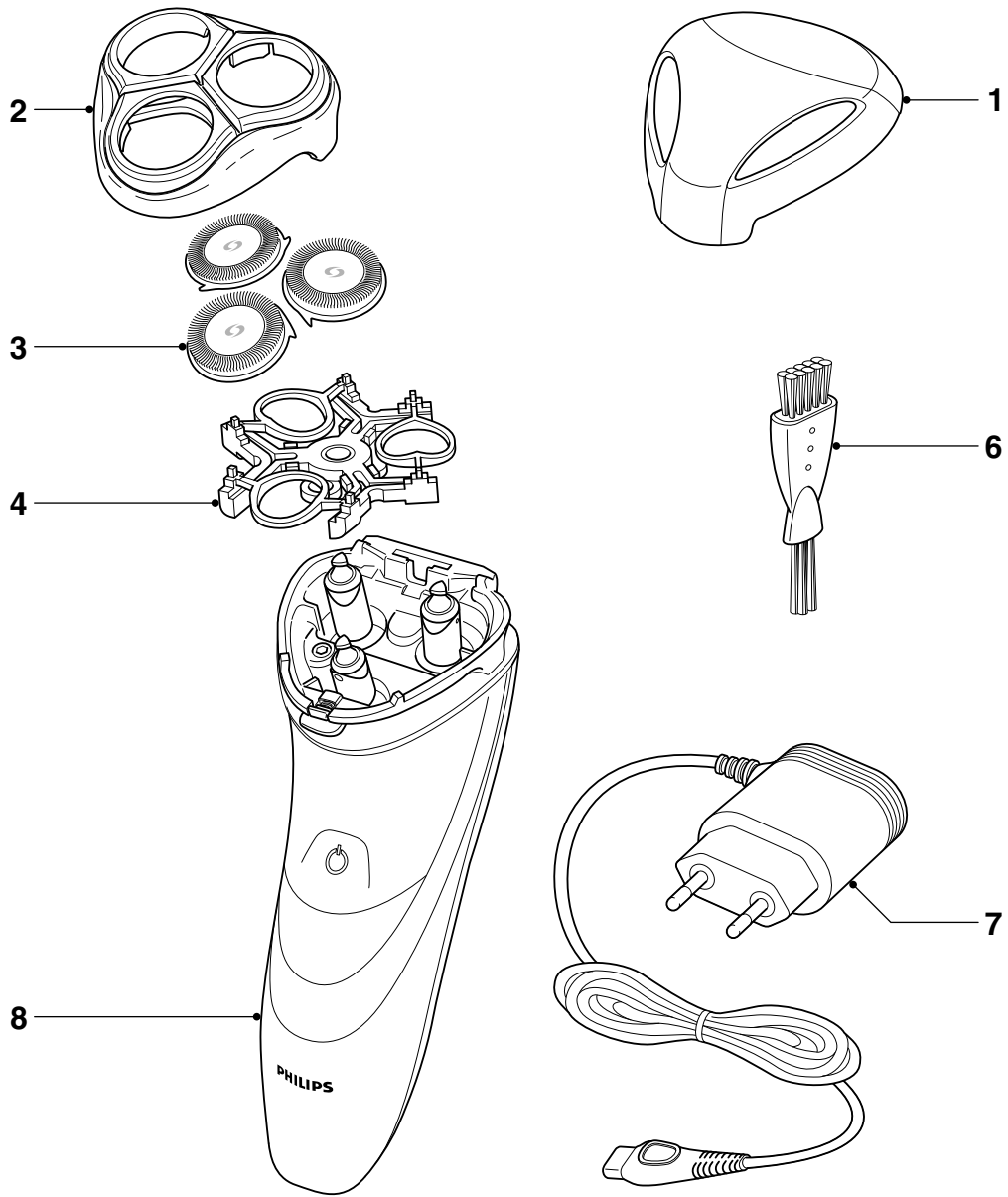

Pos	Flextronics	Singapore	Description
	Service code	Service code	
1	4222 027 23801	4222 036 19971	Protecting cap
2	4222 036 20411	4222 036 18651	Bracket assy
3	4222 036 22161	4222 036 18451	Shaving head
4	4222 036 18701	4222 036 18581	Holder assy
6	4222 036 02770	4222 036 02770	Brush
7	see optional	see optional	Power plug
8	-	4222 036 22131	Handle USA
8	4222 036 23231	-	Handle ROW
	4222 018 58631	-	Pouch