

Service  
Service  
**Service**

**FC7070/01**  
**FC7070/11**  
**FC7070/61**  
**FC7070/81**



Philips Consumer Lifestyle

# Service Manual

## PRODUCT INFORMATION

- This product meets the requirements regarding interference suppression on radio and TV.
- After the product has been repaired, it should function properly and has to meet the safety requirements as officially laid down at this moment.
- All removable parts are dishwasher proof.

## TECHNICAL INFORMATION

- Voltage : 220 V / 230 V
- Frequency : 50 Hz
- Power Consumption (IEC) : 450 W
- Colour setting : Dark midnight & Lime Yellow
- Weight : 7,5 kg
- Dimensions L x W x H (cm)  
Appliance on Drip tray : 117,2 x 38,2 x 36,4
- Clean Water Tank Capacity : 0,7 L
- Dirty Water Tank Capacity : 1,0 L

## (OPTIONAL) Accessories

- Replacement brushes - FC8054
- Drip tray

## Electrical diagram:

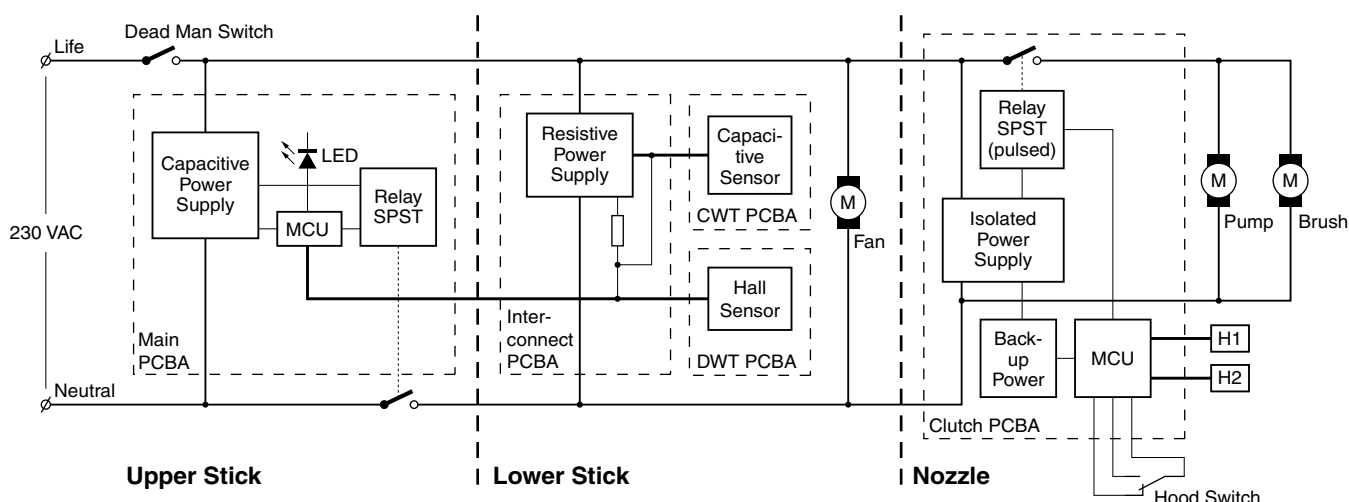

## DISASSEMBLY- AND RE-ASSEMBLY ADVISE

The system consists of three major parts:

- Upper Stick
- Lower Stick
- Nozzle

### Upper / Lower stick

**Remove the decorative front covers of both the Upper Stick and Lower stick.**

To prevent scratches or damage it is advisable to detach the decorative covers and store them aside. To remove the decorative cover of the upper stick, take a small flat-head screwdriver and unlock the six snaps as indicated in the illustration below. Carefully move the panel forward, there are eight pillars guiding the panel on the frame behind.

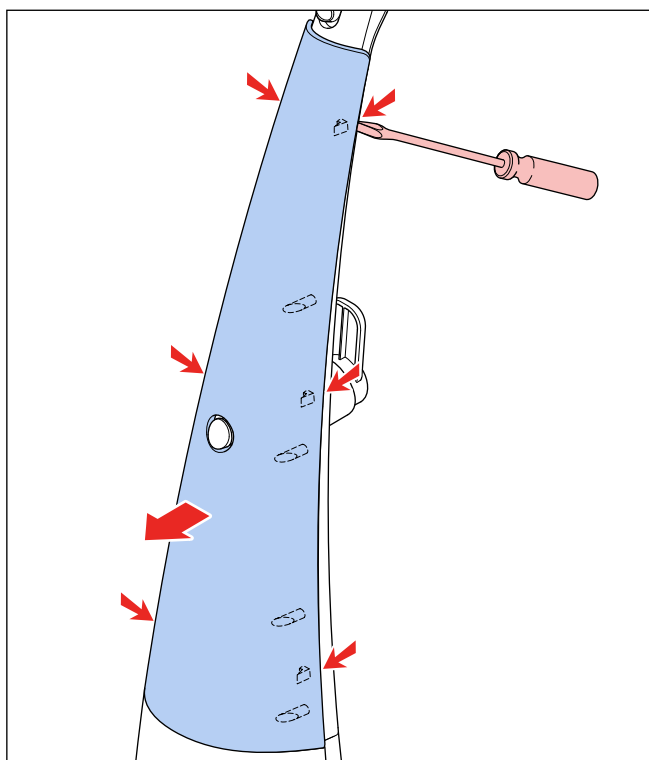

To remove the decorative cover of the lower stick, take a small flat-head screwdriver and unlock the eight snaps as indicated in the illustration below. Carefully move the panel forward, there are eight pillars guiding the panel on the frame behind.

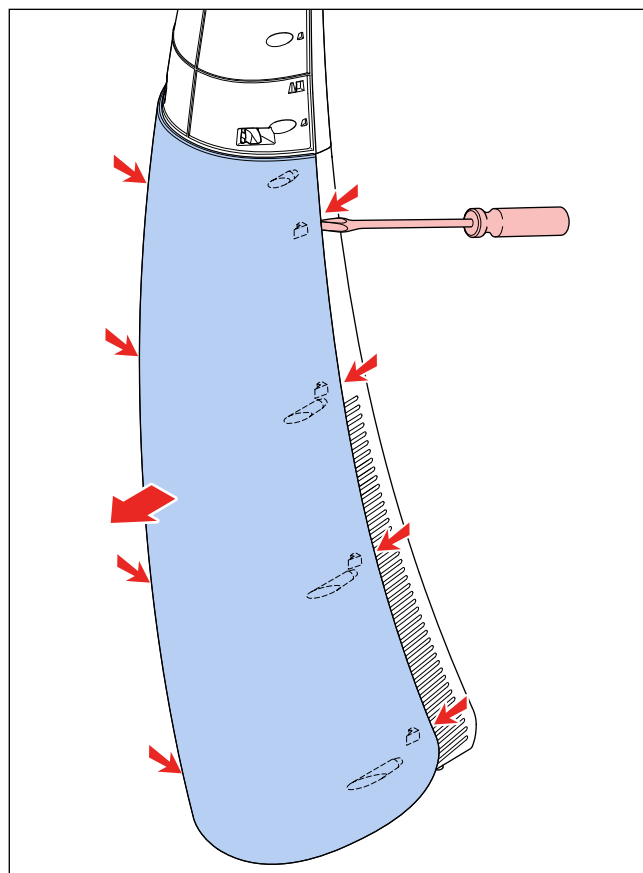

**Remove the complete stick from the nozzle.**

To be able to open the Upper Stick assy and Lower Stick assy the stick needs to be removed from the Nozzle, to do so unscrew the screw **K** holding the Clamp in place. Carefully open the Clamp and separate the Stick from the Nozzle. Please notice to orientation of the several connectors inside the joint. Within the joint are two electrical connections and two water connections present. Especially the electrical and small clean water connectors are fragile, considering the weight of the stick, please handle them with care during reinstallation.

At this point, also remove the Joint housing from the lower stick by unscrewing the four screws **F**.

**Open the Upper Stick assy and Lower Stick assy.**

When a new appliance arrives at the consumer, the Upper Stick assy is separated from the Lower Stick assy. The consumer connects the Upper Stick assy to the Lower Stick assy, this is a one-time only connection and cannot be undone by the consumer. Service can disconnect these parts again.

First remove the ten screws **A** from the Front Housing and operate the two white clamps securing the internal electrical connection from the Upper Stick assy to the Lower Stick assy. You can now remove the Front Housing panel and access the internal components

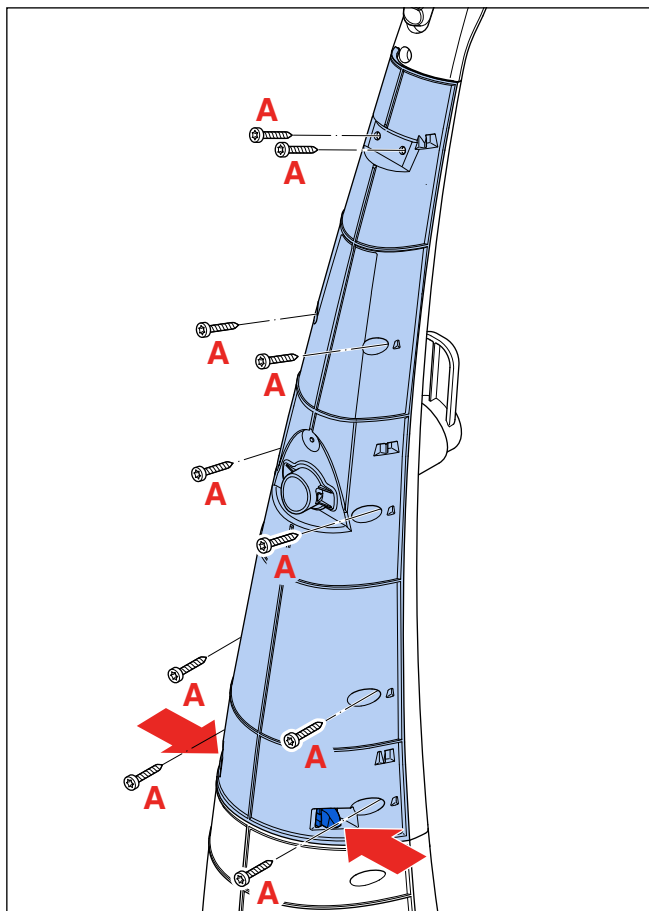

Secondly remove the ten screws **E** from the Front Frame and remove the Front Frame from the Lower Stick assy. You can now access all internal components.

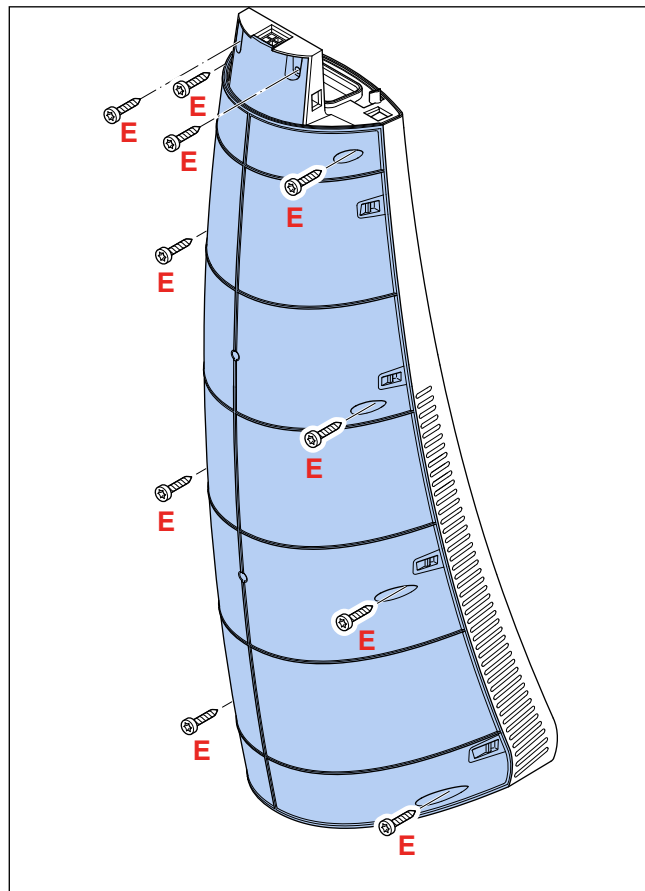

To exchange the PCBA in the Upper Stick assy, simply unlock the Positive Lock Fastons from the PCB, unlock connector **J3** and remove the PCBA from its holder.

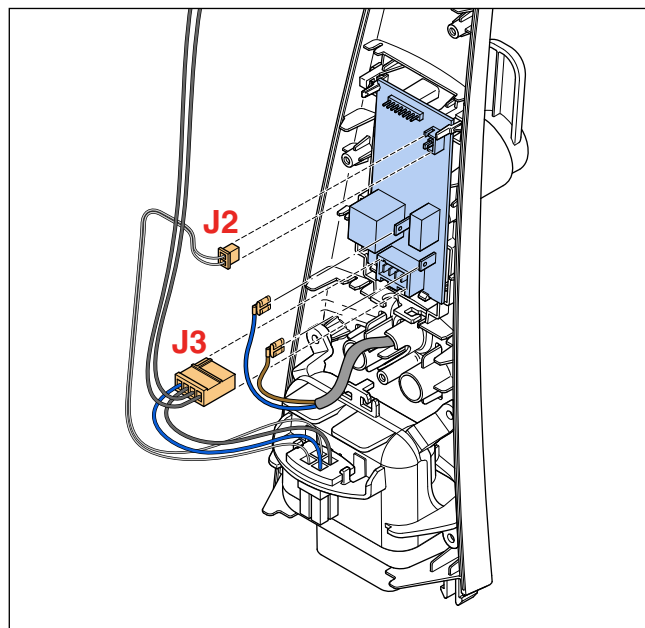

To exchange the PCBA in the Lower Stick assy, open the PCB Box and undo connectors **J3** (Main PCBA), **J4** (Clean Water sensor) and **J5** (DWT Hall sensor).

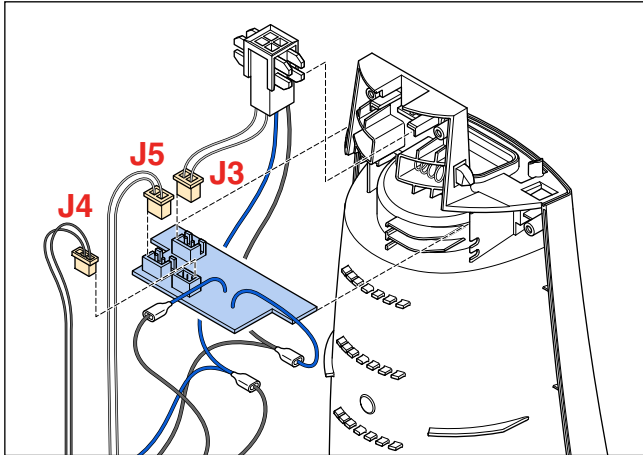

To exchange the Motor assy undo the fastons on the two black wires coming from the Motor assy going to the 4P male connector to the Upper Stick assy. Unscrew screw **J** holding the DWT Hall sensor in place, and unscrew the two screws **I** Holding the Motor assy in place. You are now able to carefully remove the Motor assy from the Lower Stick assy.

With the Motor assy removed you can also easily access the hinge construction holding the locking of the DWT handle in place. Both left and right hinge needs to be installed on the link before the hinge unit can be reinstalled in the appliance.

## Nozzle

To be able to open the nozzle, first open the hood, take out the brush cover and remove the brushes. Clean the inside of the brush compartment if necessary.

Then carefully remove the side panels left and right from the nozzle, starting from the rear of the nozzle, along the top and bottom side of the nozzle, working to the front of the nozzle, ending at the hinge of the hood. Most connections are snaps, only the mating surface with the hood is a snap over construction, there the side panel needs to be lifter upwards a little bit to become undone. Only use a flathead screwdriver when absolutely necessary, because the plastic is easily damaged.

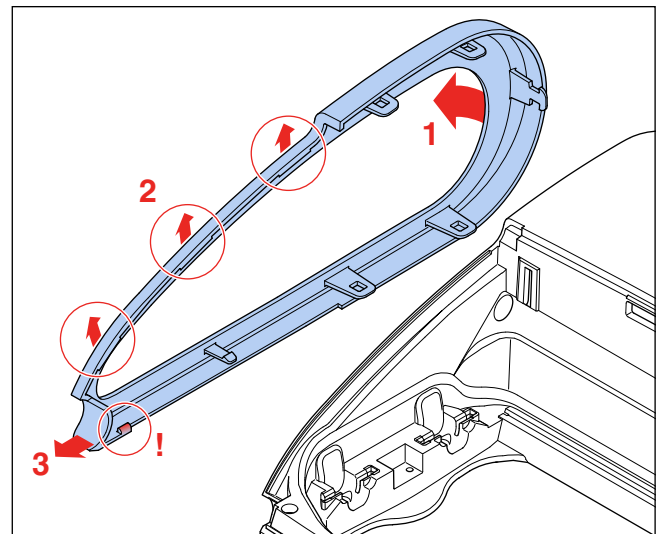

Carefully unsnap the collar from the nozzle. Next remove 11 screws **L** (2 are underneath the collar) to be able to remove the upper housing from the nozzle.

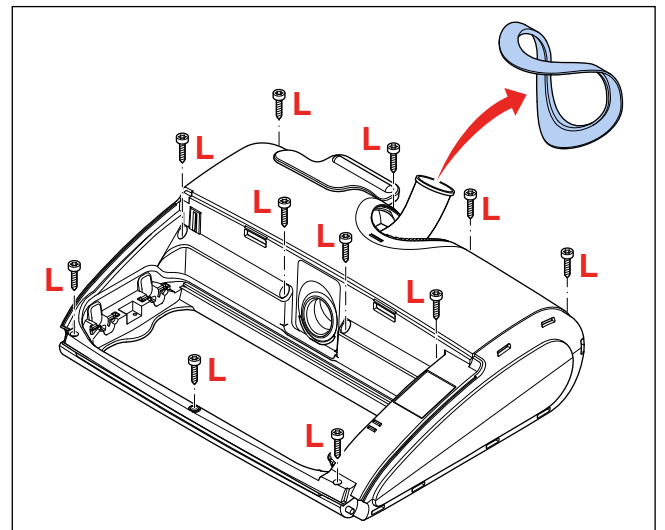

You can now easily access all components like the Nozzle PCBA, pump, suction tube, drive train etc.

When reassembling please take care that the different seals are placed back properly, keep in mind that especially the nozzle is a wet environment, and that all electronic leads are double isolated.

## PARTS LIST

FC7070/01 /11 /61 /81

Pos	Service code	Description
1	4322 005 32941	Dirty water tank lid assy
2	4322 005 31191	Dirty water tank (excl. lid)
3	4322 009 00611	Cap
4	4322 005 26841	Clean water tank assy (excl. cap)
5	4322 005 30281	Upper stick cover
6	4322 005 30121	Microswitch with cables & conn.
7	4322 006 24403	Main PCBA
8	4322 003 39361	Handle backpart
9	4322 003 39381	Grip rear
10	4322 003 39421	Cord hook
11	4322 005 31291	Sensor interface PCBA
12	4322 005 31831	Motor assy 220V
	4322 005 26861	Motor assy 230V
13	4322 005 30271	Lower stick cover
14	4322 001 74571	Clean water tube
15	4322 003 39141	Handle clean water tank
16	4322 003 39151	Clean water tank interface
17	4322 003 39131	Hinge right
18	4322 003 39121	Hinge link
19	4322 003 39671	Hinge left
20	4322 003 39111	Handle dirty water tank
21	4322 005 32851	Joint housing
22	4322 003 42281	Hood side panel left
23	4322 003 38851	Tilt mechanism pedal
24	4322 003 38721	Nozzle side panel left
25	4322 005 26761	Hood assy (excl. side panels)
	4322 005 32101	Hood assy (excl. side panels) CN
26	4322 006 24603	Nozzle PCBA
27	4322 005 32401	Microswitch assy
28	4322 001 74971	Pump cover

Pos	Service code	Description
29	4322 006 96191	Clean water pump
30	4322 003 38931	Brush cover
31	4322 003 44371	Safety bar holder
32	4322 005 26781	Brush assy
33	4322 005 30321	Mid bar assy
34	4322 005 32931	Brush coupling assy
35	4322 003 38701	Spoiler clamp back
36	4322 003 38691	Spoiler clamp front
37	4322 003 38911	Collar
38	4322 003 40351	Tilt mechanism curtain
39	4322 003 38951	Hood side panel right
40	4322 003 38711	Nozzle side panel right
41	4322 003 40341	Joint clamp
42	4322 005 31851	Drive train assy 220V
	4322 005 26721	Drive train assy 230V
43	4322 001 74621	Brush cover seal
44	4322 005 26741	Rear wheel assy
45	4322 005 26731	Front wheel assy
46	4322 003 38652	Drip tray
47	4322 001 74641	Rubber spoiler
48	4322 005 31571	Dirty water tank full sensor
49	4322 005 31262	Power cord EU
50	4322 005 32022	Power cord Swiss
51	4322 003 39372	Grip front
52	4322 005 33241	Power cord HK
53	4322 005 31942	Power cord CN
54	4322 005 26851	Upper stick assy EU
	4322 005 32031	Upper stick assy Swiss
	4322 005 33221	Upper stick assy HK
	4322 005 31951	Upper stick assy CN
55	4322 000 00371	Spring
56	4322 001 75211	Tiewrap

