

Service
Service
Service



Philips Consumer Lifestyle

Service Manual

PRODUCT INFORMATION

- This product meets the requirements regarding interference suppression on radio and TV.
- After the product has been repaired, it should function properly and has to meet the safety requirements as officially laid down at this moment.

TECHNICAL INFORMATION

- Color : Siberian Green
- Power consumption : 1400 W
(IEC) 230 V
- Maximum Air displacement : 34 l/s
- Dust storage capacity : 1.7 L
- Cord length (depending on type) : 7 m
- Filter system : Pleated cyclone-filtration system
: HEPA 10 exhaust filter
- Noise : < 82 dB

ACCESSORIES

- Nozzle : All purpose floor nozzle
- Tubes : Metal Telescopic tube
- Accessories : Crevice nozzle and small nozzle
- Accessory Storage : Tube clip
- Coupling : Conical coupling

OPTIONAL (accessories)

- HEPA exhaust filter : FC8070 (8838 070 01010)
- Motor filter incl. foam : FC8071 (8838 071 01010)

DISASSEMBLY- AND RE-ASSEMBLY ADVISE

- First remove the dust container.
- Remove the dustcover using a screwdriver (see picture).

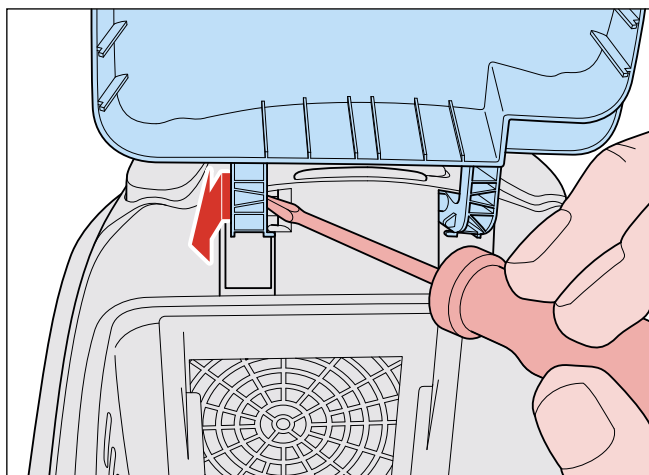

- When the dustcover has been removed, 3 of the 7 screws **D** that need to be unscrewed to disassemble the upper housing, are accessible (see picture).

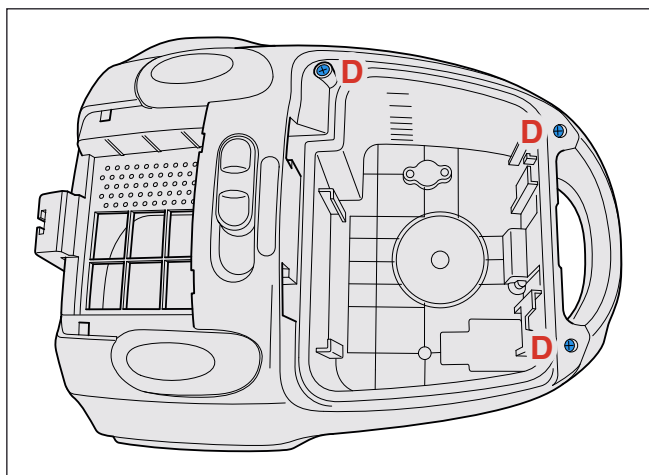

- The 4th screw **D** is hidden under the 0/I button, to remove the button use a screwdriver (see picture)

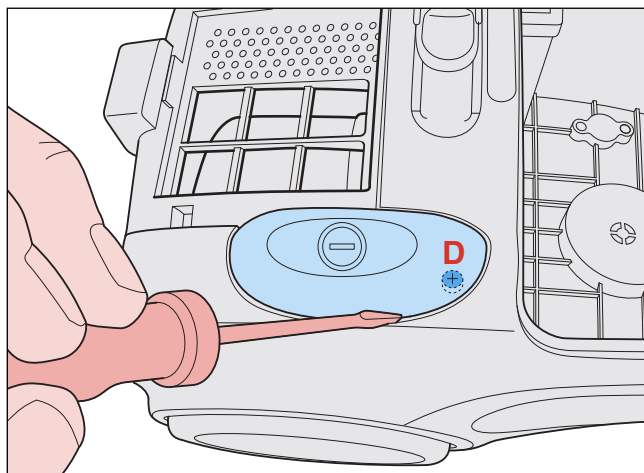

- Finally the last 3 screws **D** that need to be removed are situated at the bottom side of the appliance (see picture).

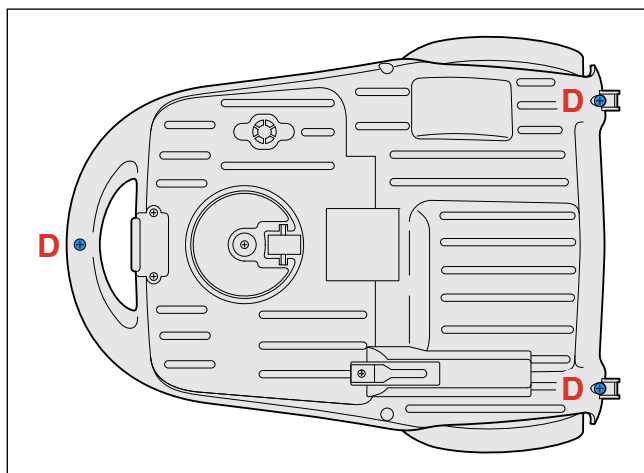

- During re-assembling, take care all the wires are positioned in the guides correctly.

REPAIR INSTRUCTION

- The spare parts have been standardized as much as possible.
- Depending on the original cord, the spare cord must be shortened to the length of the original cord.
- **Item 36**, air valve, opens to cool the motor if the air displacement is too low or if the airflow is blocked.

PARTS LIST

FC8I44/0I

Pos	Service code	Description	
1	4222 459 46231	Dustcover assy	Green
2	4222 459 46251	Dustcover latch kit	Green
3	4222 459 46241	Seal for suction	
4	4222 459 46201	Dustcup assy	Green
5	4222 459 46181	Cone assy	Green
6	4222 459 46191	Dustcup bottom seal	
7	4222 459 46161	Air inlet HEPA assy	
8	4222 459 46171	Air inlet sponge	
9	4222 459 46441	Anti missing protector kit	
10	4222 459 46461	Front wheel kit	Green
11	4222 459 46361	Right side panel	
12	4222 459 46271	Inlet filter	
13	4222 459 46261	Inlet filter frame	Green
14	4222 459 46341	Dustchamber seal	
16	4222 459 46351	Left side panel	
17	4222 459 46291	Button on/off	Green
18	4222 459 46581	Button spring	
19	4222 459 46281	Mid frame assy	Green
20	4222 459 46301	Button CW	Green
21	4222 459 46451	Sealing Motor front cover	
22	4222 459 46211	Filter panel	Green
23	4222 459 46221	Outlet HEPA assy	
24	4222 459 46381	Cordwinder complete	UK/HK
	4222 459 46391	Cordwinder complete	Europe
	4222 459 46401	Cordwinder complete	PRC

Pos	Service code	Description	
25	4222 459 46421	Back wheel assy	Green
26	9965 100 56857	Motor cover	
28	4222 459 46321	LED PCB assy	
29	4222 459 46331	Sensor PCB assy	
30	4222 459 46471	Front cover motor	
31	4222 459 46411	Rubber piston	
32	4222 459 46371	Switch	
33	4222 459 46521	Outer motor cov. assy (incl silenc.)	
34	4222 459 46771	Motor 220 V CCC	China only
	4222 459 46781	Motor 220 - 240 V	Europe
36	4222 459 46501	Protector kit motor compartment	
37	4222 459 46761	Main PCB assy 220 V CCC	
	4222 459 46311	Main PCB assy 230 V	
38	4222 459 46511	Fixation outer motor cover	
39	9965 100 56858	Motor fixation rubbers	
42	4222 459 46571	Noise red. around outer mot. cov.	
45	4222 459 46591	Hose assy	
46	4222 459 46621	Small nozzle	
47	4222 459 46641	Crevice nozzle	
49	4222 459 46141	Floor nozzle	
50	4222 459 46601	Telescopic tube (2TT)	
51	4322 004 23831	Accessory holder	
52	4222 459 49161	Cord outlet	Ink Black
53	4222 459 54621	Nozzle holder	Siberian Green

ELECTRICAL DIAGRAM

220 V CCC

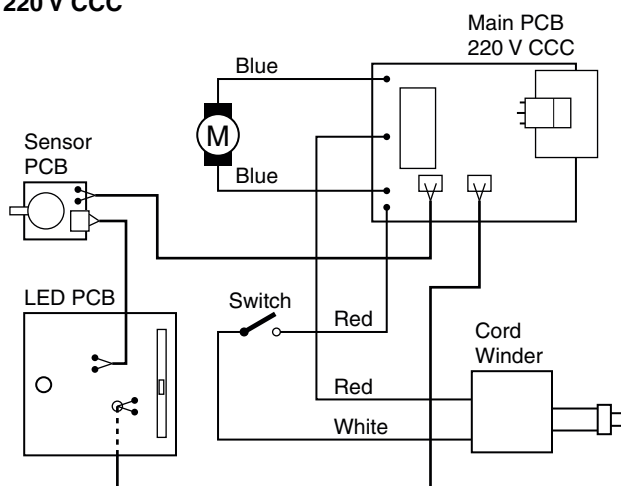

230 V

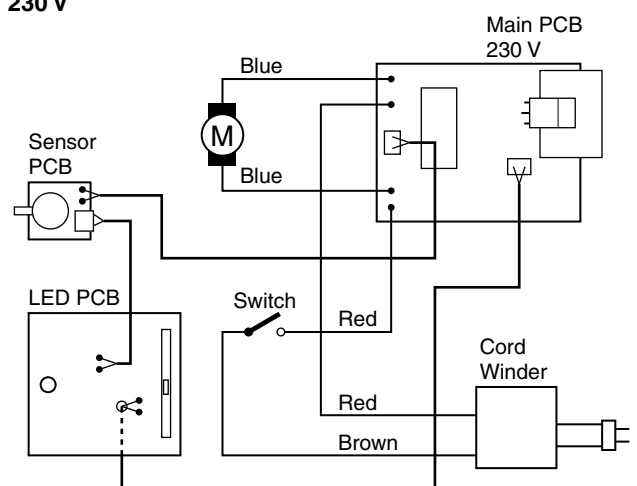

= changed

