



Philips Domestic Appliances and Personal Care

Service Manual

PRODUCT INFORMATION

Features

- Color : Grey
- SteamGlide soleplate
- Easy Reach Steam tip
- Steam output (40 gram/min)
- Shot Of Steam, SOS (100 gram/min)
- Vertical SOS (100 gram/min)
- Spray feature
- Tank capacity (335 ml)
- Cord winder & Velcro
- Cord length (3 m)
- Drip stop feature
- Double Active Calc System
- Auto Shut Off
- Ionic Deep Steam
- Soft grip

Safety Information

- This product meets the requirements regarding interference suppression on radio and TV.
- After the product has been repaired, it should function properly and has to meet the safety requirements and legal regulations as officially laid down at this moment.

TECHNICAL INFORMATION

	Voltage	: 120 V, 220 - 240 V
	Frequency	: 50 - 60 Hz
	Power	: 1300 W, 2000 - 2400 W
	Dimension (F-box)	: 335 (L) x 144 (W) x 182 (H) mm
	Weight	: 1.68 kg

= changed

Water Advice

Suitable for tap water use. Advice to mix with equal portion of distilled water or use only distilled water if the tap water is very hard.

Ionic Deep Steam

Ionization process produces smaller steam particles. The finer steam leads to deeper & better penetration into fabrics.

SteamGlide Soleplate

The specially treated SteamGlide soleplate is designed with 2 distinctly different types of steam vents:

1. Large vents for maximum crease removal
2. Fine vents for best glide

Easy Reach Steam Tip

Concentrated steam delivered in the hard to reach places by pointed shape & the elongated steam slots.

Double Active Calc System

This is a 2-step system to protect your iron from scale build-up:

1. The anti-calc tablet prevents scale from clogging the steam vents.
2. The calc-clean function flushes out any loose scale particles still inside the iron.

Drip Stop Feature

Water is released into the steam chamber via the tank valve when the soleplate temperature is high enough. When temperature is too low, the tank valve is closed by means of a bi-metal disc.

Auto Shut Off

The iron shuts off automatically if remain motionless for 30 sec in horizontal position or 8 min in vertical position.

BACKPLATE 7

BALL SWIVEL 8

- Remove Screw A
- Remove BACKPLATE 7

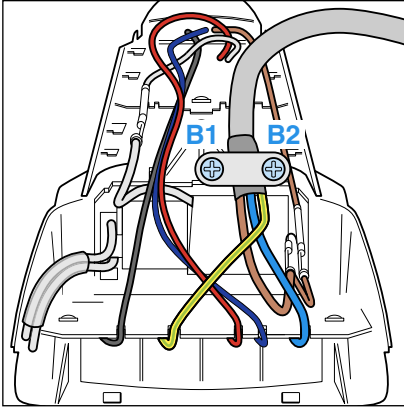

FILLING DOOR ASSY 10

INLAY ASSY 11

SOS KNOB 24

SPRAY KNOB 25

ASO ASSY 27

IONIC ON/OFF BUTTON 33

LIGHT RING 34

- Remove Screws B1, B2
- Remove Cord Clamp
- Release 2x rear catches of INLAY ASSY 11
- Remove INLAY ASSY 11

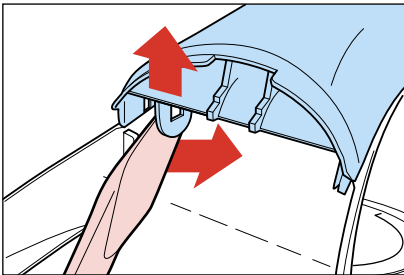

TANK SEAL 21

HOUSING ASSY 22

THERMOSTAT BUSH 28

THERMOSTAT PLATE PRINTED 29

THERMOSTAT RING 30

AESTHETIC RING 31

SOFT TOUCH SNAP-ON 35

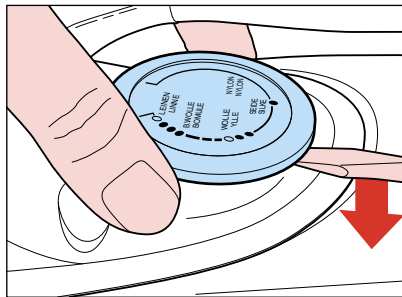

- Remove Thermostat dial
- Remove Screws C1, C2
- Remove Screws D1, D2
- Remove HOUSING 22

WATER TANK ASSY 14

PUMP ASSY 16

SPRAY NOZZLE ASSY 17

STEAM SHAFT ASSY 18

DOSING CAM 19

CLAMP BRACKET 20

- Remove Screws E1, E2
- Remove Screw F
- Remove WATER TANK ASSY 14
- Remove Screws G1, G2
- Remove CLAMP BRACKET 20

COVER SPRAYED 1

SOLEPLATE MOUNTED ASSY 2

SOS SEAL 3

DOISING SEAL 5

HEAT SHIELD 6

IONISER ASSY 36

- Remove Screw H1
- Remove HEAT SHIELD 6
- Remove IONISER ASSY 36

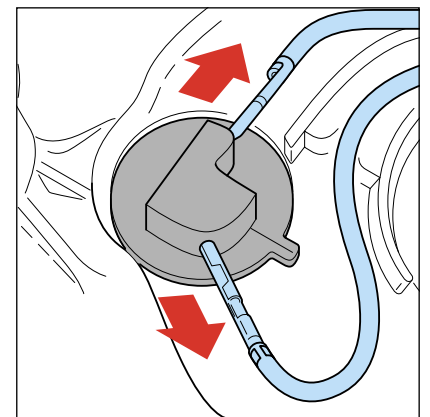

- Remove Screws H2, H3
- Remove COVER SPRAYED 1

- Due to the high wattage of the iron, only the specified cord set must be used.
- Should damage be observed on the CORDSET 26, it must be replaced. Continued usage is not allowed.
- If COVER 1 is provided without type plate information eg. type number, voltage etc. When replacing the cover, engrave the type number & voltage on the type plate with a sharp object.
- After the product has been repaired, it should function properly and has to meet the safety requirements & legal regulations as laid down & officially established at this moment.
- The following tests are common checks that are conducted on a repaired product before it is returned to the consumer.

1. Soleplate temperature

Check that soleplate temperature is within IEC requirement.

Measure the temperature of the soleplate after the iron has reached steady state i.e connected to the mains for at least 15 minutes. The table below shows the temperature requirement.

Marking	Soleplate temperature (Deg C)			Material, for example
	Minimum	Maximum	Nominal + Tolerance	
• (1 dot)	70	120	95 ± 25	Acetate, elastane, polyamide, polyproylene
•• (2 dots)	100	160	130 ± 30	Cupro, polyester, silk, triacetate, viscose, wool
••• (3 dots)	140	210	175 ± 35	Cotton, linen

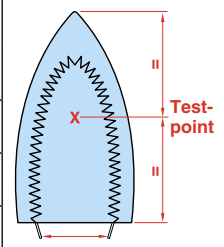

2. Leakage current

Check that leakage current is within IEC requirement.

Measure leakage current between LIVE/NEUTRAL & EARTH.

IEC requirement is that at 230 V supply, the EARTH leakage current must be less than 0.75 mA.

3. Water leakage / Functionality

Check that there is no water leakage from any part of the product during operation.

Check that the functionality of the product (product dependent) eg. steaming, variable steam, SOS, ASO etc is working properly.

4. Loose part

Check that there are no loose parts eg. extra screw in the product that can cause short-circuit or product malfunction.

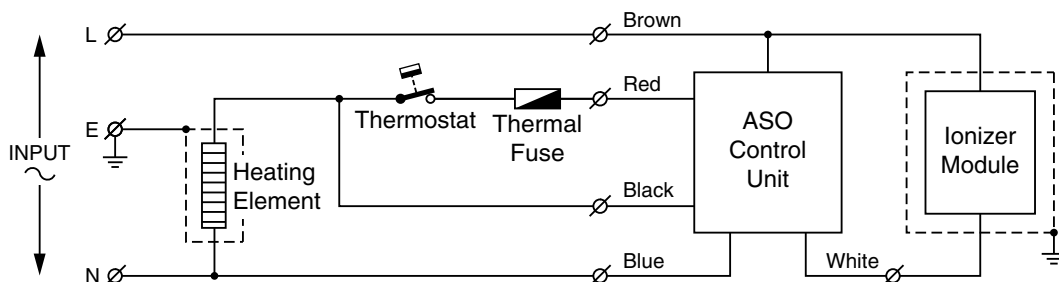

Pos	Service code	Description
1	4239 015 40080	Cover sprayed inscribed (Tonic ice)
	4239 015 40330	Cover sprayed inscribed (Tonic ice) - East EU
	4239 015 40480	Cover sprayed inscribed (Tonic ice) - Swiss
2	4239 021 42190	Soleplate mounted assy 120 V
	4239 021 35710	Soleplate mounted assy 230 V
3	4239 015 51450	SOS seal
4	4239 025 98250	Ryton spacer
5	4239 015 55620	Dosing seal
6	4239 010 10400	Heat shield
7	4239 026 18430	Backplate (White)
8	4239 025 92070	Ball swive (White)
9	4239 026 24860	Backplate cover (Transparent grey)
10	4239 021 36600	Filling door assy (Transparent grey)
11	4239 021 36630	Inlay assy (White)
12	4239 026 24350	Lamp cover
13	4239 026 25000	Steam slider (Transparent grey)
14	4239 021 36720	Water tank assy (Transparent grey)
	4239 021 41640	Water tank assy (Transparent grey) - China
	4239 021 43130	Water tank assy (Transparent grey) - Taiwan
	4239 021 42860	Water tank assy (Transparent grey) - Australia
15	4239 021 22540	Valve bellow assy
16	4239 020 90560	Pump assy
17	4239 021 03040	Spray nozzle assy
18	4239 021 22590	Steam shaft assy
19	4239 026 17220	Dosing cam
20	4239 026 17230	Clamp bracket
21	4239 015 55610	Tank seal
22	4239 021 37310	Housing assy
23	4239 014 54180	Rattle spring
24	4239 026 25130	SOS knob (Vapor blue)
25	4239 026 25160	Spray knob (Vapor blue)
26	4239 000 09950	Cordset EU
	4239 000 10000	Cordset Swiss
	4239 000 10160	Cordset China
	4239 000 10010	Cordset Taiwan
	4239 000 10180	Cordset Australia/New Zealand
	4239 000 09990	Cordset Singapore
27	4239 021 37900	ASO assy 120 V
	4239 021 35920	ASO assy 230 V
28	4239 026 17320	Thermostat bush
29	4239 021 37890	Thermostat plate printed - Ger/Swe
	4239 021 38000	Thermostat plate printed - Fre/Dut
	4239 021 38010	Thermostat plate printed - Ita/Spa/Por
	4239 021 38660	Thermostat plate printed - Eng
	4239 021 38920	Thermostat plate printed - Eng/Chinese
30	4239 026 25190	Thermostat ring (Vapor blue)
31	4239 021 36850	Aesthetics ring (Tonic ice)
32	4239 026 05990	Filling cup
33	4239 021 36690	Ionic on/off button printed
34	4239 026 24360	Light ring
35	4239 026 25090	Soft touch snap-on (Vapor blue)
36	4239 021 40480	Ionizer module assy 120 V
	4239 021 35890	Ionizer module assy 230 V
38	4239 021 37070	Chamber top

