



Philips Consumer Lifestyle

Service Manual

PRODUCT INFORMATION

- Temperature light
- Non-slip feet
- Grease tray
- Reversible grill plate
- This product meets the requirements regarding interference suppression on radio and TV.
- After the product has been repaired, it should function properly and has to meet the safety requirements as officially laid down at this moment.

DISASSEMBLY- AND RE-ASSEMBLY ADVISE

- No specific issues.

REPAIR INSTRUCTION

- No specific issues.

OPTIONAL (accessories)

- No specific issues.

TECHNICAL INFORMATION

- Voltage : 220 - 240 V
- Frequency : 50 / 60 Hz
- Power consumption : 1500 W
- Cord length : 1 m
- Color(s) : Steel / Black
- Materials : Plastic housing
ALU plates
Metal parts
- SAP coding : HD6320/20
HD6320/21

• Weight and dimensions:

- Grill plate dimensions (W x D) : 319 x 223 mm
- Product dimensions (W x H x D) : 405 x 280 x 315 mm
- Weight appliance : 3.9 kg

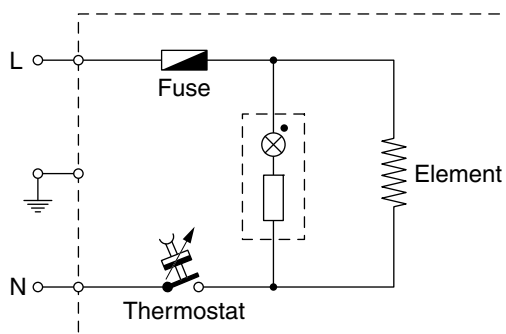

PARTS LIST & EXPLODED VIEW

HD6320/20 HD6320/21

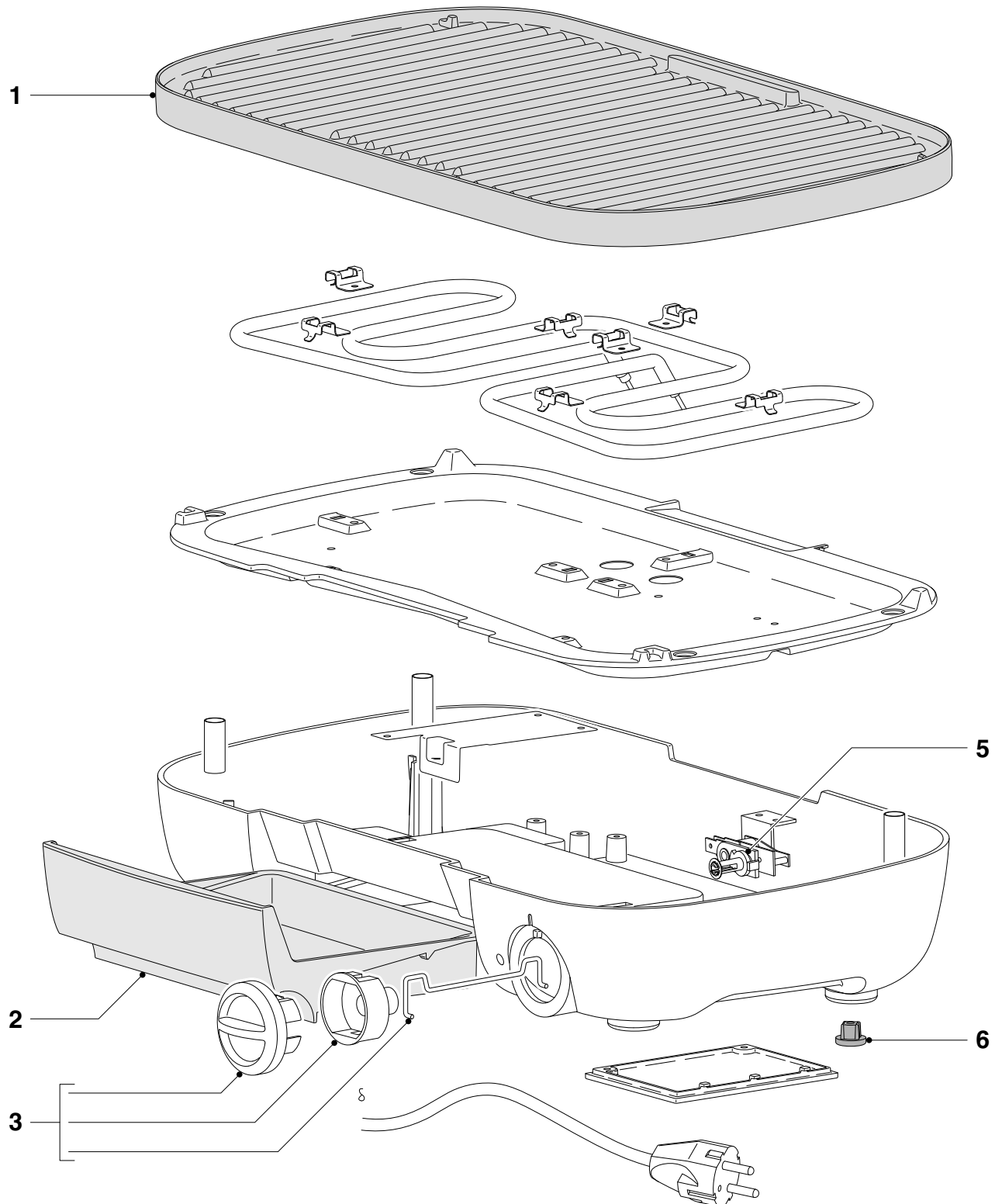

Pos	Service code	Description
1	4222 459 5326I	Reversible Grill plate
2	4222 459 5327I	Grease Tray
3	4222 459 5361I	Knob assy
5	4222 459 5362I	Thermostat
6	4222 459 5469I	Rubber feet (4 pcs)