

**Philips Domestic Appliances and Personal Care**

# Service Manual

**PRODUCT INFORMATION****Shaving system**

- 3-dimensional contour following system
- Super Lift & Cut system
- Used shaving lotion
- Waterproof

**Power system**

- Rechargeable
- 8 hour charge time
- Up to 55 minutes cordless shaving time
- World-wide automatic voltage selection

**Features**

- Travel pouch
- Cartridge holder
- Trimmer

**Luxe**

\*\*\*\*\*

**Safety information**

- This product meets the requirements regarding interference suppression on radio and TV.
- After the product has been repaired, it should function properly and has to meet the safety requirements as officially laid down at this moment.

**OPTIONAL (accessories)**

- Travel pouch

**DISASSEMBLY- AND RE-ASSEMBLY ADVISE**

- Remove the shaving unit to prevent damage during repair.
- Remove the outer cover (item 19) and cartridge (item 20).
- Remove 5 A1 screws.

**TECHNICAL INFORMATION**

- Voltage : 100-240 V AC 50-60 Hz
- Power consumption : Motor depending
- Motor Voltage : 1,2 V
- Power system : Rechargeable
- Shaving heads : HQ177 - 4222 036 09810
- Display : Batt full/low  
Charge indicator  
Cleaning indication  
Replace shaving head indication  
Use additive indication  
Travel lock  
Demo mode
- SAP coding : HQ7780

**REPAIR INSTRUCTION**

- After the cover (item 12) has been removed, it must be checked if its sealing has not been damaged.
- The cover (item 12) contains a sticker that is permeable to gas yet impermeable to water.  
This sticker may not be removed under any circumstances.
- Unsolder the motor connector and remove the PCB.
- To replace the motor or the driving unit (parts of item 6), screws B1 must be removed first.  
Then push the entire unit out of the housing (item 8) and check if its sealing is damaged.
- The entire driving unit is supplied as a single part to guarantee optimal sealing of the gear shafts.
- A replacement of the pump button is only possible after removal of the hair chamber (item 5).
- To guarantee that the shaver is completely watertight, only the original screws may be used.
- To charge the shaver only the original power plug may be used.

**PLEASE NOTE!!**

When the HQ7760 is handed in for service with one of the following complaints:

- Does not charge
- Battery runs out very quickly
- No capacity
- Display does not work properly
- Shaver does not work or suddenly stops working

And the production code shows that they were produced before week 0408, replace the PCB.

Shavers with production code week 0408 or after have been provided with new software.

Service code PCB : 4222 036 09890

# PARTS LIST & EXPLODED VIEW

# HQ7780

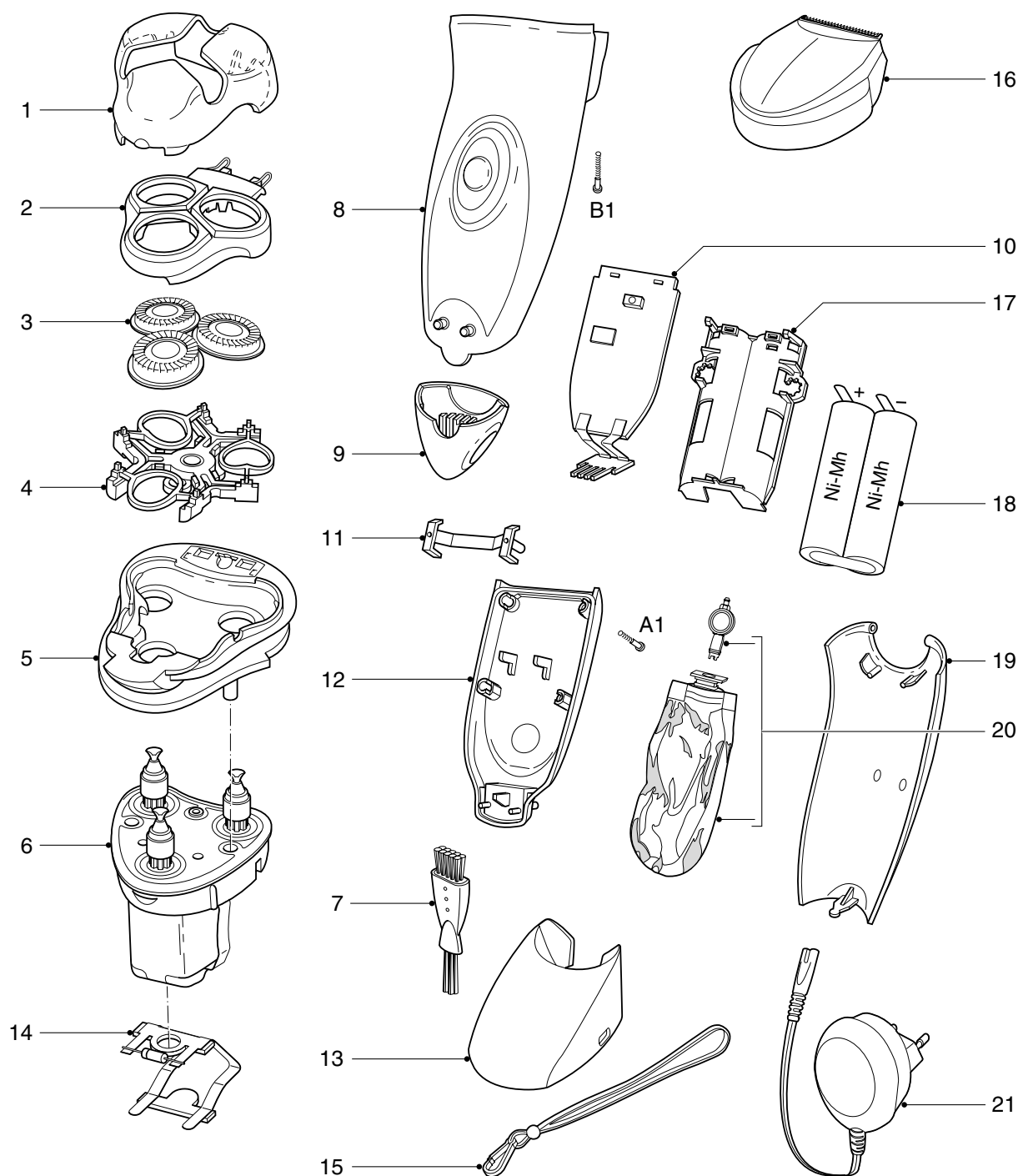

Pos	Service code	Description
1	4222 036 09790	Protecting cap Neptunus
2	4222 036 09800	Bracket assy
3	4222 036 09810	Shaving head (HQ177)
4	4222 036 09820	Holder assy
5	4222 036 10220	Hair chamber
6	4222 036 09840	Driving unit
7	4222 036 09850	Cleaning brush
8	4222 036 10230	Housing
9	4222 036 09880	Tail part
10	4222 036 09890	Power supplier
11	4822 256 10454	Bridge
12	4222 036 09900	Cover assy
13	4222 036 10000	Stand
14	4222 036 09930	Conneting strip assy

Pos	Service code	Description
15	4222 036 10010	Hanging cord
16	4222 036 10070	Trimmer
17	4222 036 09960	Battery holder
18	4822 138 10728	NiMh pack AA
19	4222 036 09970	Outer cover
20	4222 036 10620	HQ170 5 pack sensitive
21	4222 036 04080	Power plug EUR
	4222 036 04090	Power plug GBR
	4222 036 04850	Power plug KOR
	4222 036 05110	Power plug CAN
	4222 036 05120	Power plug AUS
A	4822 502 14544	Screw
B	4822 502 14545	Screw
	4222 036 10020	Pouch