



Philips Domestic Appliances and Personal Care

# Service Manual

## PRODUCT INFORMATION

### General:

- Rechargeable / Main shaver
- Constant motor voltage
- Electronic push on/off
- Washable

### Safety information

- This product meets the requirements regarding interference suppression on radio and TV.
- After the product has been repaired, it should function properly and has to meet the safety requirements as officially laid down at this moment.

## TECHNICAL INFORMATION

- Voltage : 100 - 240 Volt 50 - 60 Hz
- Motor voltage : 3,6 Volt
- Speed of cutters : > 2100 r.p.m.
- Shaving heads : HQ8 - 4222 036 05820
- Battery capacity indication : Polymer LED
- Battery full indication : Polymer LED
- Battery low indication : Polymer LED
- Charge indication : Polymer LED
- Battery : Li-ion
- SAP coding : HQ8894

## DISASSEMBLY- AND RE-ASSEMBLY ADVISE

### Disassembly:

- Remove shaving unit, to prevent damages during repairing.
- Remove screws A1 (2x).
- Take cover from housing (trimmer must be opened).

- Remove bracket large (17). (see figure 1)
- The PCB-board can now be removed out of the housing.
- Remove the connecting strip from the motor by dis soldering.
- Remove screws B1 (2 x), now the motor and hairchamber can be removed out of the housing.
- Detach the motor springs (14) from the gearwheel unit with a small screwdriver.

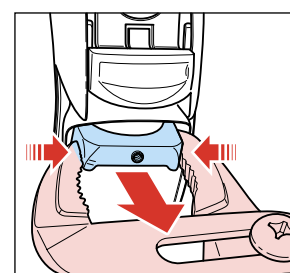

figure 1

### Assembly:

- Think by assembly on the hooks from the connecting strip assy. (see figure 2)

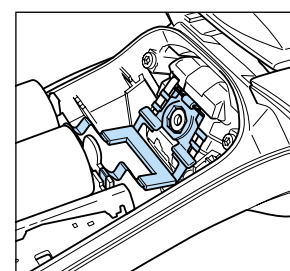

figure 2

## REPAIR INSTRUCTION

- No specific issues

### OPTIONAL (accessories)

- No specific issues

## FAST SOLUTION FOR THE NEXT PROBLEM:

- The shaver stops while the batteries are just recharged.
- No signal that the shaver has to be recharged.
- Stops during shave.
- Still minutes left on the display

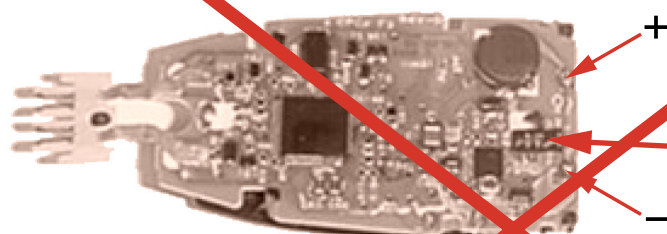

Service code number  
4222 036 10460

### Note:

Capacitor provided may deviate from type shown.

### Warning:

While soldering, be careful not to make a short circuit between the battery (-) terminal coil and motor (+) terminal. This may cause permanent damage to the battery and electronics

### Mounting:

Mount the capacitor as shown (see picture) on the solder points of the connecting strip assy. Be sure to connect the (-) terminal of the capacitor (-) (see silkscreen mark on top of the PCB) and the (+) terminal to the (+) Reversed mounting may cause permanent damage to the shaver.

**Use only the new mains from Euroservice Eindhoven.**

## PARTS LIST

Pos	Service code	Description
1	4222 036 05770	cleaning brush
2	4222 036 06380	housing
3	4222 036 06790	power plug EUR
	4222 036 04080	power plug EUR
	4222 036 04020	power plug AUS
	4222 036 03970	power plug GBR
	4222 036 04090	power plug GBR
	4222 036 06800	power plug CAN/TW/VEN
	4222 036 05110	power plug CAN/TW/VEN
	4222 036 04030	power plug MEX
	4222 036 04000	power plug KOR
	4222 036 08930	power plug JAP
	4222 036 04040	power plug PRC
4	4222 036 05800	protecting cap
5	4222 036 05810	bracket
6	4222 036 05820	HQ8 shaving heads
7	4222 036 06390	mains
8	4222 036 05840	holder assy
9	4222 036 06450	hair chamber
10	4222 036 05410	driving unit

Pos	Service code	Description
11	4822 466 12233	dust seal
12	4822 522 10763	pinion
13	4222 036 01800	motor
14	4822 492 71735	motor spring
15	4222 036 09020	connecting strip assy
16	4222 036 05870	trimmer assy
17	4222 036 05880	bracket large
18	4222 036 06400	spacer AA
19	4222 036 06410	Li-ion Batt
20	4222 036 06420	cover
21	4222 036 05910	rubber seal
22	4222 036 06480	poly-led assy
23	4222 036 06470	poly-led bracket
24	4222 036 06460	poly-led reflector
25	4222 036 10890	stand EUR
26	4222 036 10860	clock
A1	4222 036 08470	screw J0
B1	4222 036 05930	screw 1ADU
	4222 036 06430	pouch
	4222 036 06440	stand

