

**Philips Consumer Lifestyle**

ServiceManual

PRODUCT INFORMATION

- This product meets the requirements regarding interference suppression on radio and TV.
- After the product has been repaired, it should function properly and has to meet the safety requirements as officially laid down at this moment.

TECHNICAL INFORMATION

- Voltage : 200 - 240 V
- Frequency : 50 / 60 Hz
- Motor power consumption : 400 W
- Cordlength (free length) : 1.0 m
- Colour : Bright white +
Cornsilk yellow

DISASSEMBLY- AND RE-ASSEMBLY ADVISE

- No specific issues.

REPAIR INSTRUCTION

- No specific issues.

OPTIONAL (accessories)

- No specific issues.

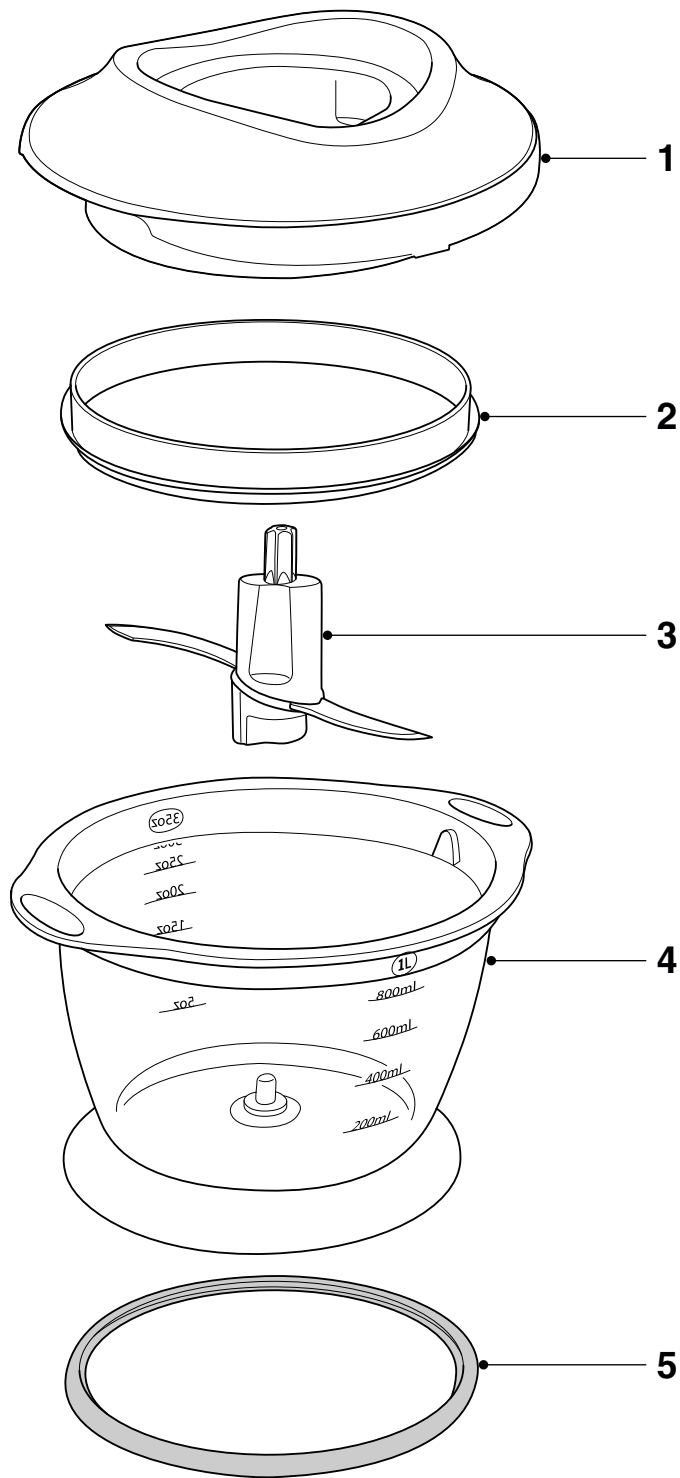

Pos	Service code	Description
1	4203 035 85490	Chopper Lid
2	4203 035 85500	Anti spill ring
3	9965 000 41747	Chopper knife
4	4203 035 85510	Chopper Bowl
5	4203 035 85520	Anti slip ring



Pos	Service code	Description
6	4203 035 90220	Housing + Decor inlay + Screws
7	4203 035 90230	Motor Assy + Mounting plate + Gearwheel + Washer
8	4203 035 90240	Bottom + Pin + 2x Cover Plug
9	4203 035 90250	Driving Coupling + Gearwheel + 2x Washer
10	4203 035 90260	Cordset Assy WEu
	4203 035 90270	Cordset Assy CH
11	4203 035 90280	Switch knob assy
12	4203 035 90290	Switch knob holder + Spring
13	4203 035 90300	Screws (6x) + Cable fixer