



Philips Consumer Lifestyle

Version: A

Service Manual

PRODUCT INFORMATION

- This product meets requirements regarding interference suppression on radio and TV.
- After the product has been repaired, it should function properly and has to meet the safety requirements as officially laid down at this moment.

DISASSEMBLY – AND RE-ASSEMBLY ADVISE

- No specific issues

REPAIR INSTRUCTION

- No specific issues

OPTIONAL (accessories)**Dimensions:**

- Length : 270 mm
- Width : 245 mm
- Height : 430 mm (incl. pusher)
- Weight : 4320 g
- Cordset length: 1 m

TECHNICAL INFORMATION:**- High Voltage Versions:**

- Voltage : 220 V - 240 V
- Frequency : 50 Hz - 60Hz
- Type plate Wattage : 1000 W

- Low Voltage Versions:

- Voltage : 110 V - 127 V
- Frequency : 50 Hz - 60 Hz
- Type Plate Wattage : 1000 W

- Input Power : 1000 W
- Speeds : 2 speeds
(1: 7500 - 2: 10000 rpm)
- Pulp Container : Integrated
- Juice Jug : 1250 ml + 20 % margin
(incl. foam separator)
- Sieve : Stainless steel
- Juice collector : Yes
- Juicer lid with feeding tube : 81 mm
- Lid fixation locking arm : Yes
- Pusher : Yes
- Spout : Yes
- Drip Stop : Yes (detachable)
- Cleaning brush : No
- Feet : Rubber inserts
- Cord storage : Yes (Manual around feet)
- Housing materials : Stainless steel metal wrap
- Dishwasher friendly parts : Yes (all detachable parts)

Used materials:

Housing	: ABS
Bottom	: PP
Feet base	: PA 6.6
Feet insert	: EPDM rubber
Speed knob Base Knob	: ABS
Knob cover	: SAN
Tray body	: ABS
Pulp indication window	: SAN
Spout body	: POM
Spout tube	: Stainless steel
Spout accessory	: ABS
Juicer lid body	: SAN
Juicer ring safety ring	: ABS
Pusher	: ABS
Pulp container	: ABS
Sieve	: Stainless steel
Sieve coupling	: Polyphenylenoxid incl. 30 % Fibers (PPO GF30)
Juice jug	: SAN
Foam seperator	: ABS

Pos	Service code	Description
1	4203 036 08681	Pusher complete
2	4203 035 96731	Lid
3	4203 035 96741	Juice collector
4	4203 035 96751	Integrated pulp container
5	4203 035 96761	Spout accessory
6	4203 035 96771	Detachable spout
7	4203 035 96781	Filter
8	4203 035 96791	Juice jug + Lid
9	4203 035 96801	Driving shaft
10	4203 035 96811	Main housing with metal wrap + Motor crussion and Stopper
11	4203 035 96821	Rubber ring
12	4203 035 96831	Bottom incl. Current limiter
13	4203 035 96841	Anti slip ring
14	4203 035 96851	On/Off knob
15	4203 035 96861	On/Off switch electronic
16	4203 035 96871	Safety switch
17	4203 035 96881	Brack Switch support assembly
18	4203 035 96891	Plastic holder for On/Off switch
19	4203 035 96901	Locking arm
20	4203 035 96911	Locking arm stopper right
21	4203 035 96921	Locking arm stopper left
22	4203 035 96931	PCBA 220 - 240 V
23	4203 035 96941	CCL motor 220-240V 50/60 Hz
24	4203 035 96951	Power cord WEu
	4203 035 96961	Power cord CN
	4203 035 96981	Power cord UK
	4203 035 99611	Power cord AUS

Exploded view (CRP's)

HR 1871/70

HR 1871/71

HR 1871/72

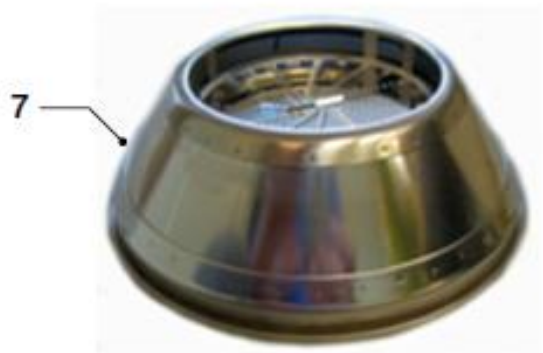

Exploded view (repair)

HR 1871/70

HR 1871/71

HR 1871/72



Repair instruction

HR 1871/70

HR 1871/71

HR 1871/72

1) Remove the Bottom

First you have to remove the anti slip ring.



2) Change the driving shaft

First you have to remove the bottom – see point 1

Remove the cap,
use a small screw driver

Turn both screws to the left direction,
And hold the motorschaft on the back side



3) Change the motor

First you have to remove the driving shaft – see point 2

Then remove the 3 caps and the 3 screws on the top of housing.

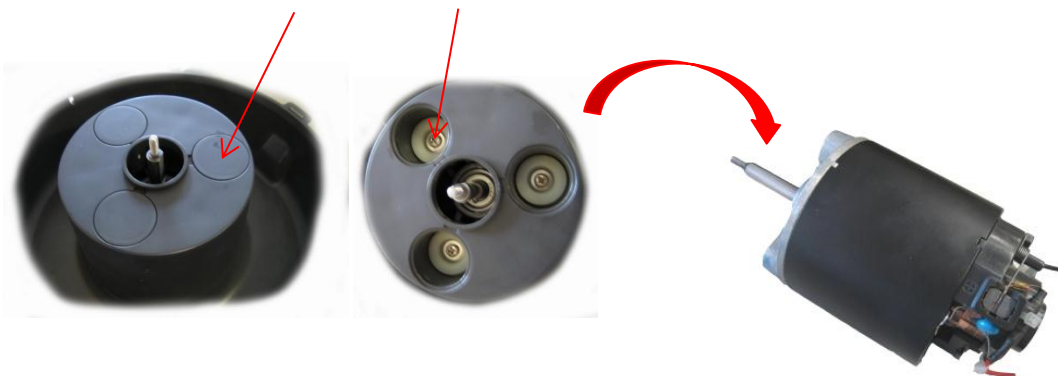

4) Remove the safety switch

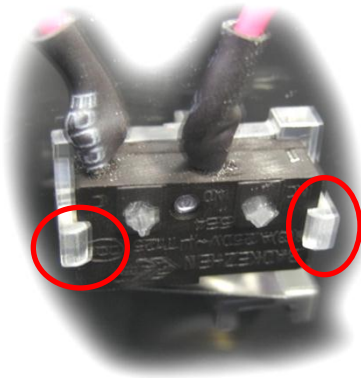

When you open both flaps
you can remove the safety switch

5) Remove the locking arm

Remove on each side the springs.

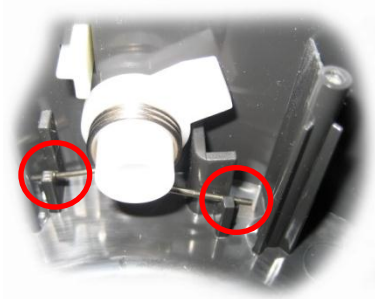

Open the screw on both sides



Circuit wire:

HR 1871/70
HR 1871/71
HR 1871/72

