



Service Manual

PRODUCT INFORMATION

- This product meets requirements regarding interference suppression on radio and TV.
- After the product has been repaired, it should function properly and has to meet the safety requirements as officially laid down at this moment.

DISASSEMBLY – AND RE-ASSEMBLY ADVISE

- No specific issues

REPAIR INSTRUCTION

- No specific issues

OPTIONAL (accessories)**Dimensions:**

- Length : 270 mm
- Width : 245 mm
- Height : 430 mm (incl. pusher)
- Weight : 4320 g
- Cordset length: 1 m

TECHNICAL INFORMATION:**- High Voltage Versions:**

- Voltage : 220 V - 240 V
- Frequency : 50 Hz - 60Hz
- Type plate Wattage : 1000 W

- Low Voltage Versions:

- Voltage : 110 V - 127 V
- Frequency : 50 Hz - 60 Hz
- Type Plate Wattage : 1000 W

- Input Power : 1000 W
- Speeds : 2 speeds
(1: 7500 - 2: 10000 rpm)
- Pulp Container : Integrated
- Juice Jug : 1250 ml + 20 % margin
(incl. foam separator)
- Sieve : Stainless steel
- Juice collector : Yes
- Juicer lid with feeding tube : 81 mm
- Lid fixation locking arm : Yes
- Pusher : Yes
- Spout : Yes
- Drip Stop : Yes (detachable)
- Cleaning brush : No
- Feet : Rubber inserts
- Cord storage : Yes (Manual around feet)
- Housing materials : Stainless steel metal wrap
- Dishwasher friendly parts : Yes (all detachable parts)

Used materials:

| | |
|-------------------------|--|
| Housing | : ABS |
| Bottom | : PP |
| Feet base | : PA 6.6 |
| Feet insert | : EPDM rubber |
| Speed knob Base Knob | : ABS |
| Knob cover | : SAN |
| Tray body | : ABS |
| Pulp indication window | : SAN |
| Spout body | : POM |
| Spout tube | : Stainless steel |
| Spout accessory | : ABS |
| Juicer lid body | : SAN |
| Juicer ring safety ring | : ABS |
| Pusher | : ABS |
| Pulp container | : ABS |
| Sieve | : Stainless steel |
| Sieve coupling | : Polyphenylenoxid incl. 30 % Fibers (PPO GF30) |
| Juice jug | : SAN |
| Foam seperator | : ABS |

| Pos | Service code | Description |
|-----|----------------|---|
| 1 | 4203 036 08681 | Pusher complete |
| 2 | 4203 035 96731 | Lid |
| 3 | 4203 035 96741 | Juice collector |
| 4 | 4203 035 96751 | Integrated pulp container |
| 5 | 4203 035 96761 | Spout accessory |
| 6 | 4203 035 96771 | Detachable spout |
| 7 | 4203 035 96781 | Filter |
| 8 | 4203 035 96791 | Juice jug + Lid |
| 9 | 4203 035 96801 | Driving shaft |
| 10 | 4203 035 96811 | Main housing with metal wrap + Motor crussion and Stopper |
| 11 | 4203 035 96821 | Rubber ring |
| 12 | 4203 035 96831 | Bottom incl. Current limiter |
| 13 | 4203 035 96841 | Anti slip ring |
| 14 | 4203 035 96851 | On/Off knob |
| 15 | 4203 035 96861 | On/Off switch electronic |
| 16 | 4203 035 96871 | Safety switch |
| 17 | 4203 035 96881 | Brack Switch support assembly |
| 18 | 4203 035 96891 | Plastic holder for On/Off switch |
| 19 | 4203 035 96901 | Locking arm |
| 20 | 4203 035 96911 | Locking arm stopper right |
| 21 | 4203 035 96921 | Locking arm stopper left |
| 22 | 4203 035 96931 | PCBA 220 - 240 V |
| 23 | 4203 035 96941 | CCL motor 220-240V 50/60 Hz |
| | 4203 036 09911 | CCL Motor (CN) |
| 24 | 4203 035 96951 | Power cord WEu |
| | 4203 035 96961 | Power cord CN |
| | 4203 035 96981 | Power cord UK |
| | 4203 035 99611 | Power cord AUS |

Exploded view (CRP's)

HR 1871/70

HR 1871/71

HR 1871/72

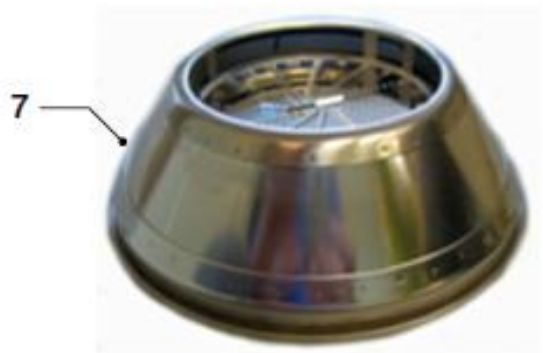

Exploded view (repair)

HR 1871/70

HR 1871/71

HR 1871/72



Repair instruction

HR 1871/70

HR 1871/71

HR 1871/72

1) Remove the Bottom

First you have to remove the anti slip ring.



2) Change the driving shaft

First you have to remove the bottom – see point 1

Remove the cap,
use a small screw driver

Turn both screws to the left direction,
And hold the motorschaft on the back side



3) Change the motor

First you have to remove the driving shaft – see point 2

Then remove the 3 caps and the 3 screws on the top of housing.

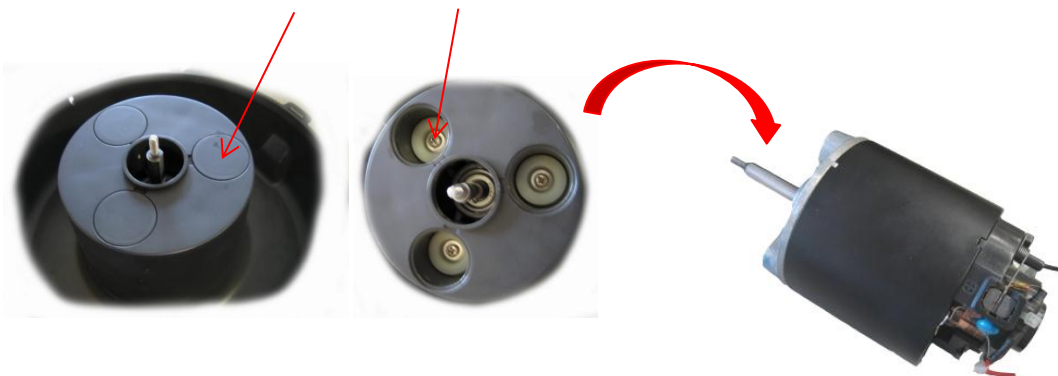

4) Remove the safety switch

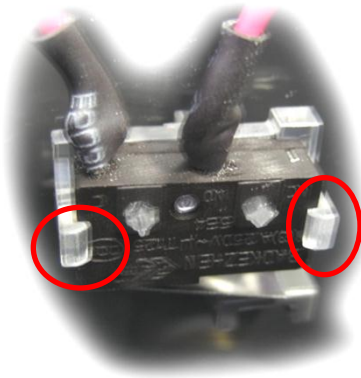

When you open both flaps
you can remove the safety switch

5) Remove the locking arm

Remove on each side the springs.

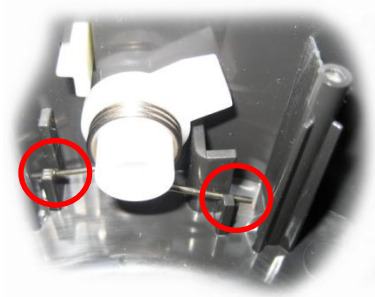

Open the screw on both sides



Circuit wire:

HR 1871/70
HR 1871/71
HR 1871/72

