



Philips Consumer Lifestyle

Service Manual

PRODUCT INFORMATION

General

- Cooling disc/container is to be kept in a 3 or 4-star freezer or freezing compartment of the refrigerator.
- The stirrer (Pos. 2) should actually be functioning when the bowl is being filled otherwise the ingredients will immediately freeze onto the cooling disc/container.

Safety

- This product meets the requirements regarding interference suppression on radio and TV.
- After the product has been repaired, it should function properly and has to meet the safety requirements as officially laid down at this moment.

Service Information

- If the cooling disc is not stored in the freezer, the bottom may bulge. Should this occur, release the overpressure inside the cooling disc by opening the valve by means of a coin.

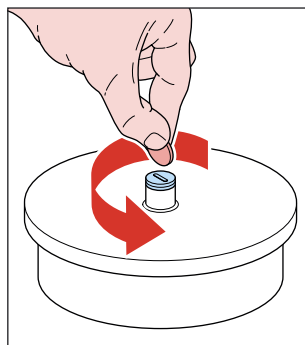

Warning!

Only open the valve to release the overpressure when the cooling disc is placed on a horizontal and solid surface !

TECHNICAL INFORMATION

- Power consumption motor : 20 W
- Voltage : 220 or 230 V - 50 Hz
: 240 V - 50 Hz
: 110 or 120 V - 60 Hz
- Cordset : 140 cm free length
- Freezing time of cooling Disc : 18 hrs

DISASSEMBLY AND RE-ASSEMBLY ADVISE

- No specific issues.

REPAIR INSTRUCTION

- No specific issues.

OPTIONAL (accessories)

- No specific issues.

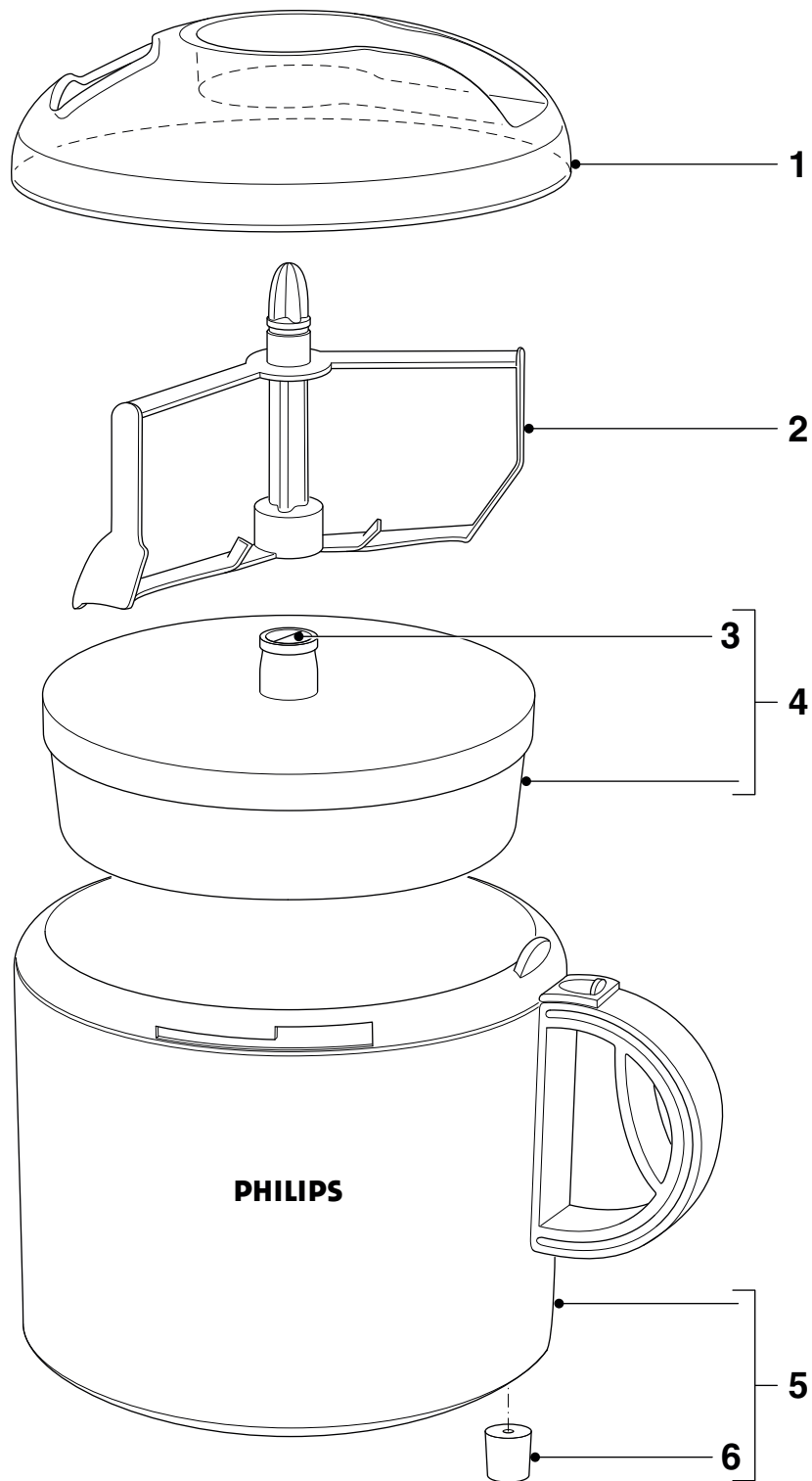

Pos	Service code	Description
1	4203 035 86900	Container Lid
2	4203 035 86910	Stirrer
3	4203 065 64810	Valve Assy
4	4822 511 90025	Cool Disc
5	4203 035 86920	Contaier (incl. Studs)
6	4822 462 40374	Stud