

Service
Service
Service



Philips Consumer Lifestyle

Service Manual

PRODUCT INFORMATION

General:

- Rechargeable
- World-wide automatic voltage selection V100 - 240

Safety information

- This product meets the requirements regarding interference suppression on radio and TV.
- After the product has been repaired, it should function properly and has to meet the safety requirements as officially laid down at this moment.

DISASSEMBLY- AND RE-ASSEMBLY ADVICE

- No specific issues

REPAIR INSTRUCTIONS

- No specific issues

TECHNICAL INFORMATION

- Voltage : 100 - 240 Volt
- Motor Voltage : 3,6 Volt
- Stand-by power : 0,5 W
- Max power consumption : 5,4 W
- Charging time : 8 hours
- Shaving time : up to 40 min
- Shaving heads : HQ8
- SAP coding : PT720

OPTIONAL (accessories)

- 2722 171 90135 Power plug BRA
- 2722 171 90077 Power plug MEX
- 2722 171 90133 Power plug KOR
- 2722 171 90137 Power plug JAP/TW
- 2722 171 90128 Power plug APAC
- 2722 171 90142 Power plug AUS
- 2722 171 90065 Power plug EUR
- 2722 171 90075 Power plug CAN/USA
- 2722 171 90389 Power plug GB
- 2722 171 90139 Power plug CN

EXPLODED VIEW & PARTS LIST

PT720

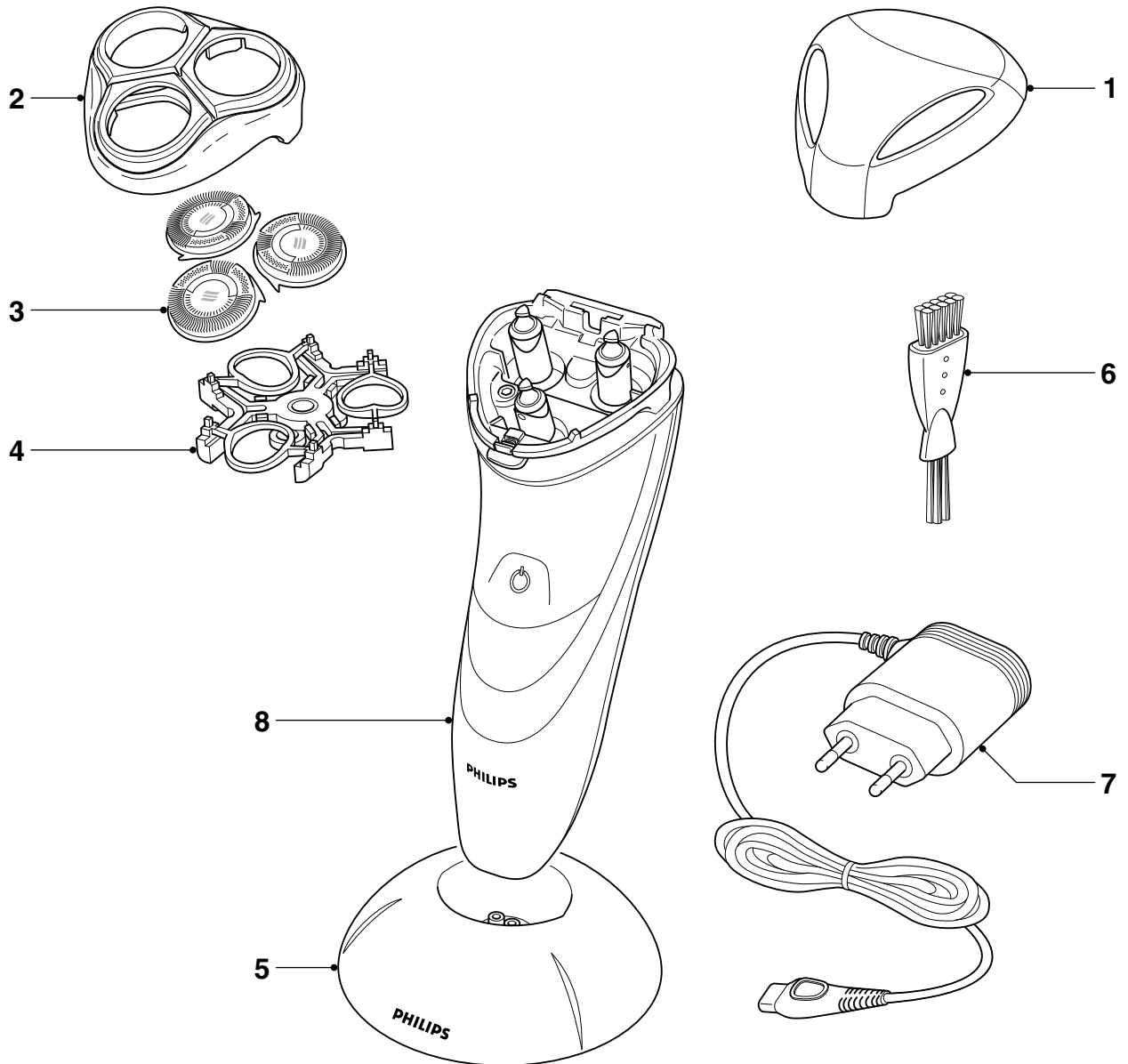

	Eindhoven	Singapore	
Pos	Service code	Service code	Description
1	4222 027 2380I	4222 036 1997I	Protecting cap
2	4222 036 1875I	4222 036 1863I	Bracket assy
3	4222 036 1845I	4222 036 1845I	Shaving head
4	4222 036 1870I	4222 036 1858I	Holder assy
5	4222 039 2449I	4222 036 2001I	Stand
6	4222 036 02770	4222 036 02770	Brush
7	see optional	see optional	Power plug
8	-	4222 036 2101I ¹	Handle JAP
8	-	4222 036 2107I ²	Handle USA
8	4222 036 2123I ³	4222 036 2114I ¹	Handle
	4222 018 5835I	4222 036 2002I	Pouch

¹ Handle will be replaced by PT735

² Handle will be replaced by PT725

³ Handle will be replaced by PT736

 = changed