

Service  
Service  
Service



Philips Consumer Lifestyle

# Service Manual

## PRODUCT INFORMATION

### General:

- Rechargeable
- World-wide automatic voltage selection V100 - 240

### Safety information

- This product meets the requirements regarding interference suppression on radio and TV.
- After the product has been repaired, it should function properly and has to meet the safety requirements as officially laid down at this moment.

## DISASSEMBLY- AND RE-ASSEMBLY ADVICE

- No specific issues

## REPAIR INSTRUCTIONS

- No specific issues

## TECHNICAL INFORMATION

- Voltage : 100 - 240 Volt
- Motor Voltage : 3,6 Volt
- Stand-by power : 0,5 W
- Max power consumption : 5,4 W
- Charging time : 8 hours
- Shaving time : up to 40 min
- Shaving heads : HQ8
- SAP coding : PT720

## OPTIONAL (accessories)

- 2722 171 90135 Power plug BRA
- 2722 171 90077 Power plug MEX
- 2722 171 90133 Power plug KOR
- 2722 171 90137 Power plug JAP/TW
- 2722 171 90128 Power plug APAC
- 2722 171 90142 Power plug AUS
- 2722 171 90065 Power plug EUR
- 2722 171 90075 Power plug CAN/USA
- 2722 171 90389 Power plug GB
- 2722 171 90139 Power plug CN

**EXPLODED VIEW & PARTS LIST**

**PT720**

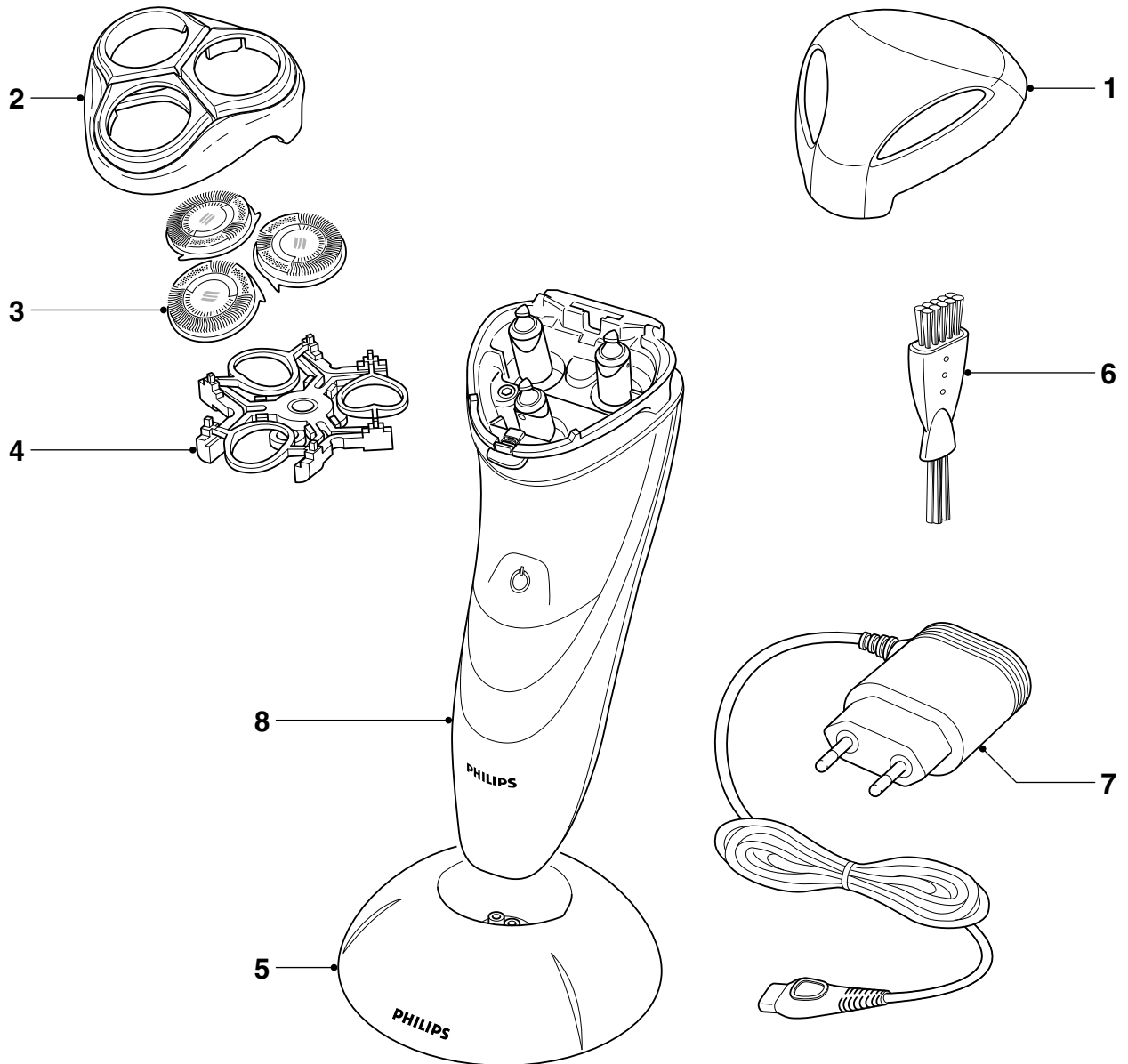

	Eindhoven	Singapore	
Pos	Service code	Service code	Description
1	4222 027 2380I	4222 036 1997I	Protecting cap
2	4222 036 1875I	4222 036 1863I	Bracket assy
3	4222 036 1845I	4222 036 1845I	Shaving head
4	4222 036 1870I	4222 036 1858I	Holder assy
5	4222 039 2449I	4222 036 2001I	Stand
6	4222 036 02770	4222 036 02770	Brush
7	see optional	see optional	Power plug
8	-	4222 036 2101I <sup>1</sup>	Handle JAP
 8	<b>4222 036 2193I</b>	4222 036 2107I <sup>2</sup>	Handle USA
8	4222 036 2123I <sup>3</sup>	4222 036 2114I <sup>1</sup>	Handle
	4222 018 5835I	4222 036 2002I	Pouch

<sup>1</sup> Handle will be replaced by PT735

<sup>2</sup> Handle will be replaced by PT725

<sup>3</sup> Handle will be replaced by PT736

 = changed