

Service  
Service  
Service



Philips Consumer Lifestyle

# Service Manual

## PRODUCT INFORMATION

### General:

- Rechargeable
- World-wide automatic voltage selection V100 - 240

### Safety information

- This product meets the requirements regarding interference suppression on radio and TV.
- After the product has been repaired, it should function properly and has to meet the safety requirements as officially laid down at this moment.

## DISASSEMBLY- AND RE-ASSEMBLY ADVICE

- No specific issues

## REPAIR INSTRUCTIONS

- No specific issues

## TECHNICAL INFORMATION

- Voltage : 100 - 240 Volt
- Motor Voltage : 3,6 Volt
- Stand-by power : 0,5 W
- Max power consumption : 5,4 W
- Charging time : 8 hours
- Shaving time : up to 40 min
- Shaving heads : HQ8
- SAP coding : PT725

## OPTIONAL (accessories)

- 2722 171 90135 Power plug BRA
- 2722 171 90077 Power plug MEX
- 2722 171 90133 Power plug KOR
- 2722 171 90137 Power plug JAP/TW
- 2722 171 90128 Power plug APAC
- 2722 171 90142 Power plug AUS
- 2722 171 90065 Power plug EUR
- 2722 171 90075 Power plug CAN/USA
- 2722 171 90389 Power plug GB
- 2722 171 90139 Power plug CN

EXPLODED VIEW & PARTS LIST

PT725

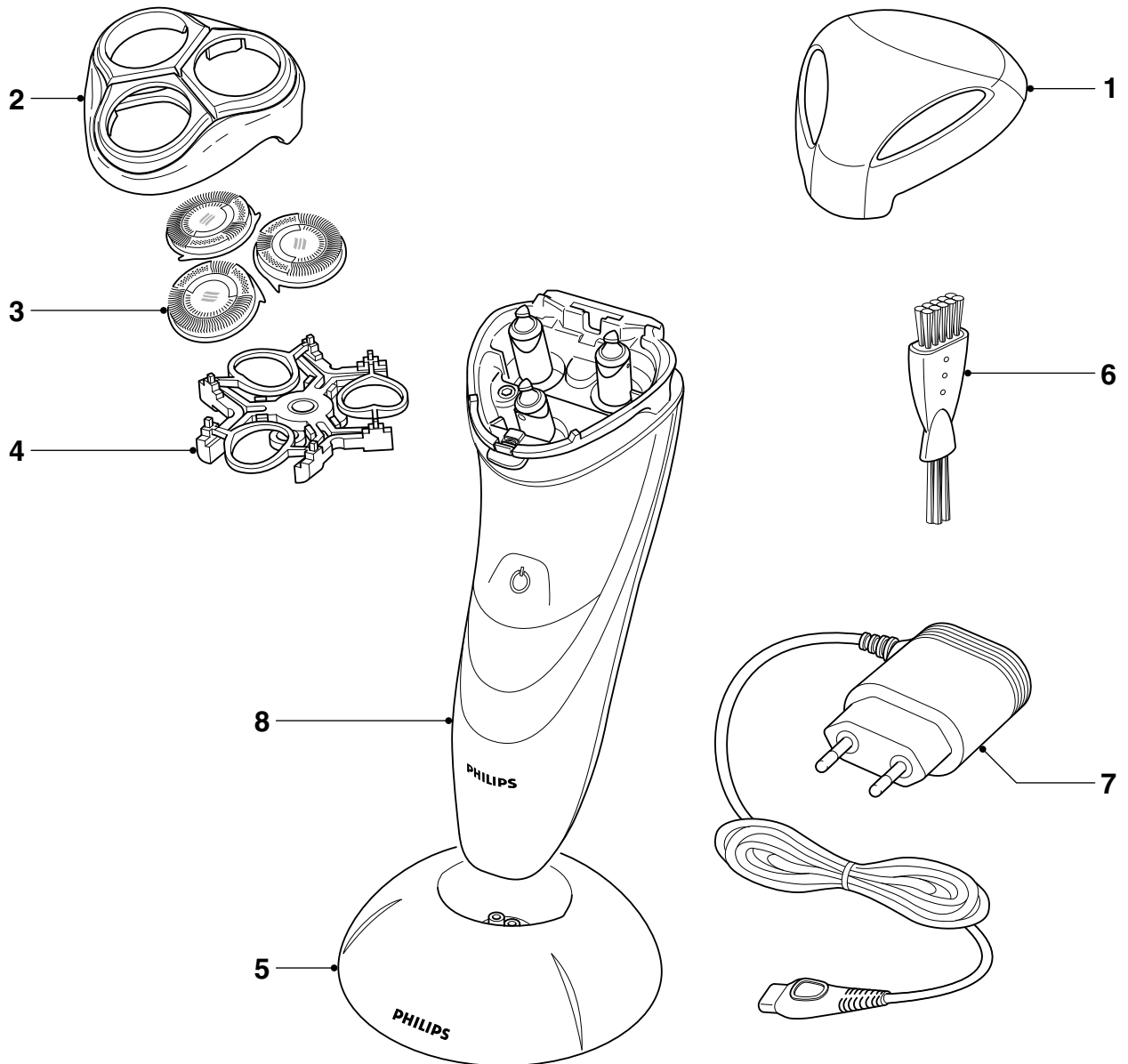

Pos	Eindhoven Service code	Singapore Service code	Description
1	4222 027 23801	4222 036 19971	Protecting cap
2	4222 036 18731	4222 036 18611	Bracket assy
3	4222 036 18451	4222 036 18451	Shaving head
4	4222 036 18701	4222 036 18581	Holder assy
5	4222 039 24491	4222 036 20011	Stand
6	4222 036 02770	4222 036 02770	Brush
7	see optional	see optional	Power plug
8	-	4222 036 21011 <sup>1</sup>	Handle <b>JAP</b>
8	-	4222 036 21071	Handle <b>USA</b>
8	4222 036 21231 <sup>2</sup>	4222 036 21141 <sup>1</sup>	Handle
	4222 018 58351	4222 036 20021	Pouch

<sup>1</sup> Handle will be replaced by PT735

<sup>2</sup> Handle will be replaced by PT736

 = changed