

Service
Service
Service



Philips Consumer Lifestyle

Service Manual

PRODUCT INFORMATION

Service scenario:

- Repair
- Parts exchange

General:

- Rechargeable
- World-wide automatic voltage selection
- Washable
- Wet & dry use (gel)

Safety information

- This product meets the requirements regarding interference suppression on radio and TV.

TECHNICAL INFORMATION

- Voltage : 100 - 240 V / 50 - 60 Hz
- Shaving heads : SH70
- Battery type : Li-ion
- Run time : up to 50 min
- Stand-by power : 0,15 W
- Max power consumption : 5,4 W
- SAP coding : S7710

OPTIONAL (accessories)

- See page Optional

Place of production date

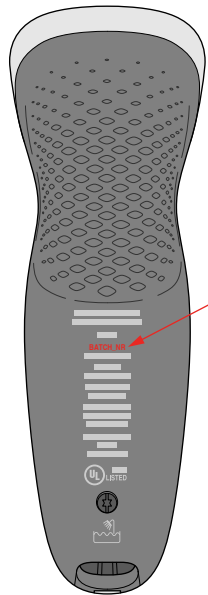

BATCH_NR 513505017
 ↓
 1350
 YYWW

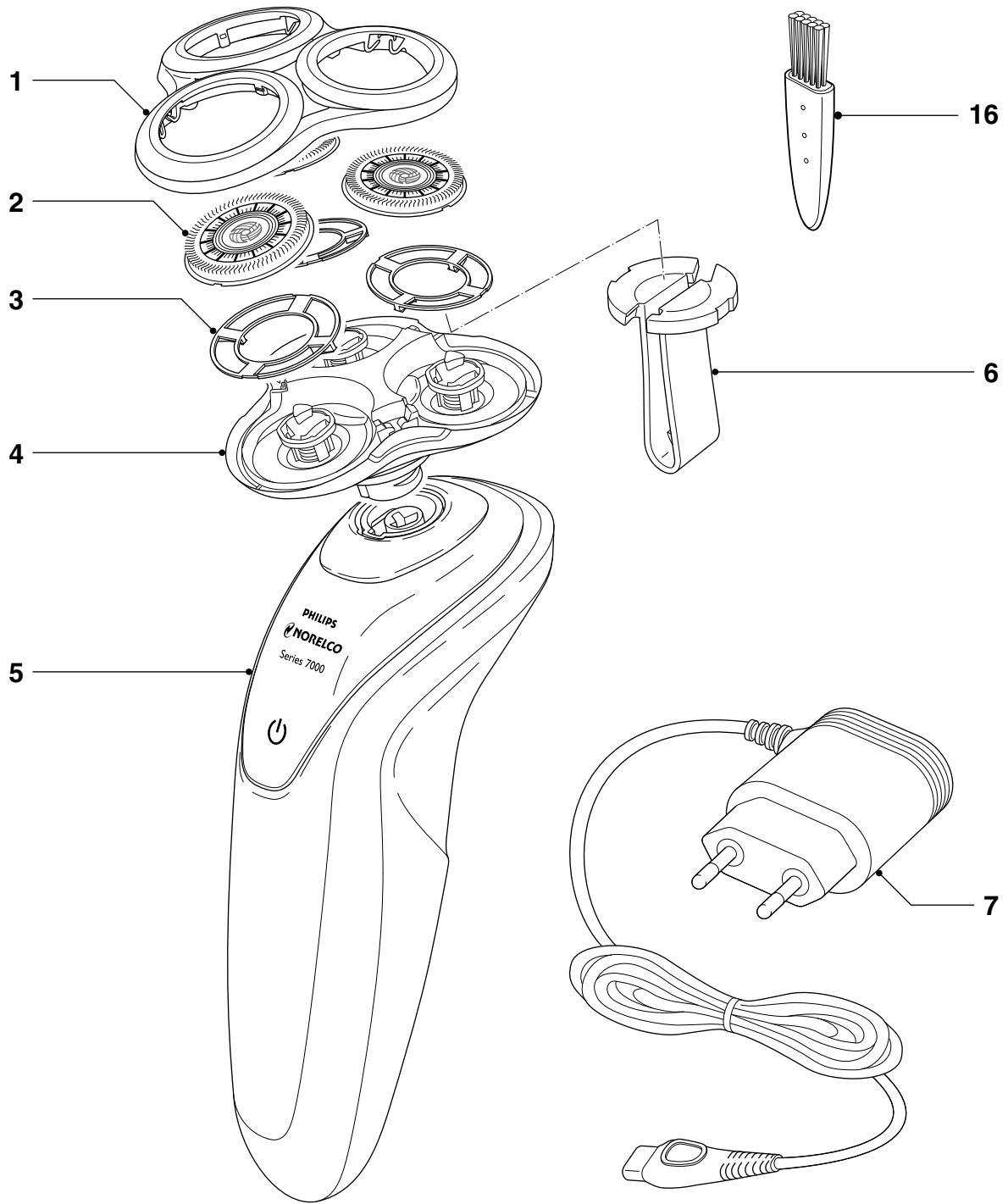

Pos	Service code	Description
1	4222 036 25231	Bracket
2	4222 036 25211	Shaving heads
3	4222 036 24351	Holder
4	4222 036 25221	Shaving unit bottom assy
5	4222 036 25311	Handle CA
5	4222 036 25641	Handle ROW *
5	4222 036 25301	Handle USA

* Handle will be replaced by S7720

■ = changed

Pos	Service code	Description
6	4222 036 24361	Holder tool
7	4222 036 23771	Power plug JA/TW/ME/US/CAN
7	4222 036 23911	Power plug CN
7	4222 036 24161	Power plug EU
7	4222 036 24021	Power plug GB
7	4222 036 24151	Power plug AUS/NZ
7	4222 036 23831	Power plug UK3
7	4222 036 24081	Power plug KR
16	4222 036 02770	Brush

OPTIONAL EXPLODED VIEW & PARTS LIST

S7710

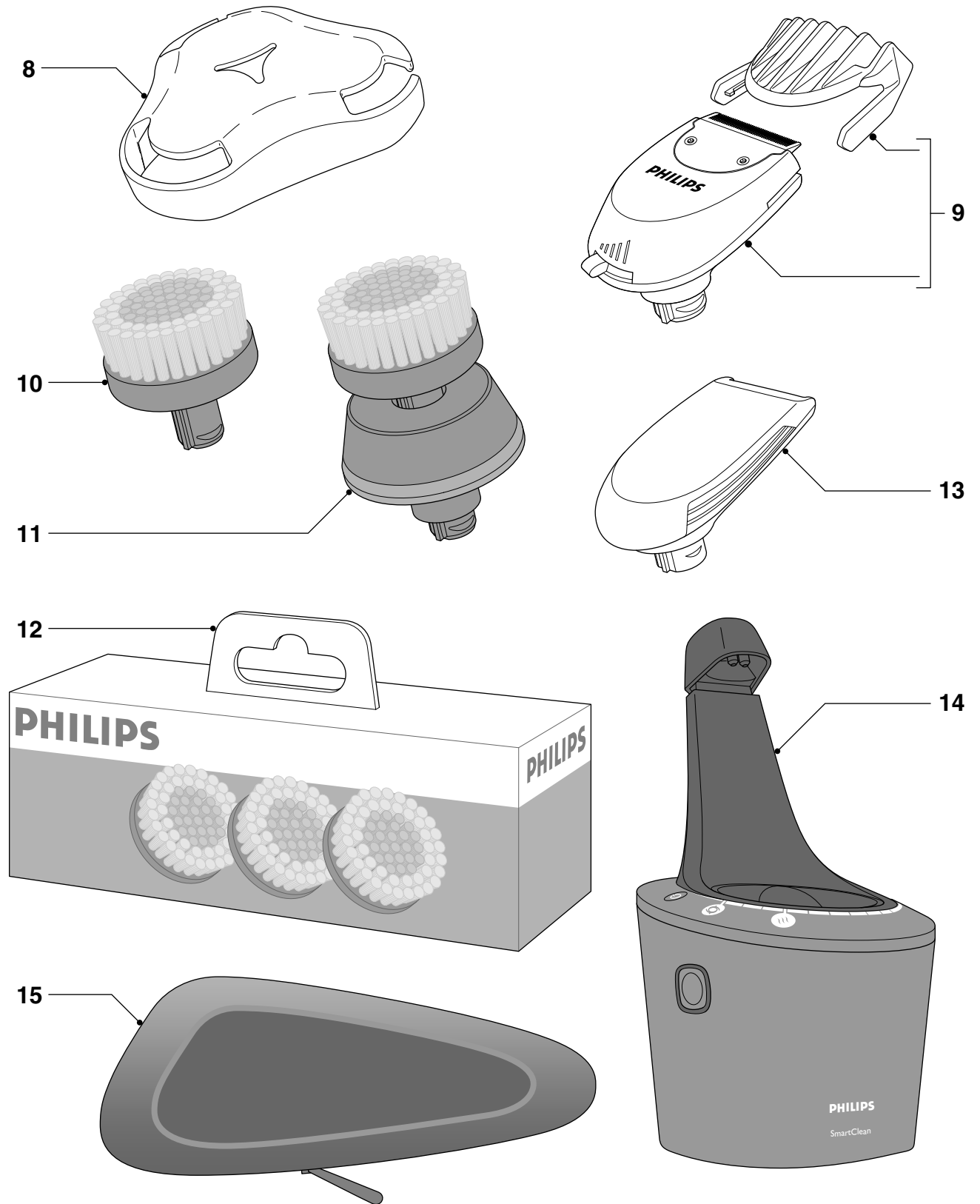

Pos	Service code	Description
8	4222 027 21541	Protecting cap
13	4222 036 26571	Precision trimmer
14	4222 039 47174	Smart clean JC5106
15	4222 018 61761	Pouch

Pos	Service code	Description
9	4222 036 25731	Styler
10	RQ560	Brush
11	RQ585	Brush + unit
12	RQ563	3 pack brush

■ = changed